



# RALLY GUIDE1

**Permanent Office Address :**

**PENGPROV. IMI - SUMUT**

Jl. Taruma No. 52

Medan 20122

Tel: +6261 452 0672

Fax: +6261 452 8821

e-mail : [info\\_sekretariat@imi-sumut.or.id](mailto:info_sekretariat@imi-sumut.or.id)

website: [www.imi-sumut.or.id](http://www.imi-sumut.or.id)

:

**Rally Headquarters Address :**

8 – 14 October 2013

Grand Aston City Hall

Balaikota Underground

Lobby Lower

Jl. Balai Kota No. 1

Medan - 20112

North Sumatera

Indonesia.



# RALLY GUIDE 1

## TABLE OF CONTENTS

1. WELCOME & INTRODUCTION

---
2. ORGANISER'S CONTACT DETAILS
  - 2.1. Permanent contact Details
  - 2.2. Rally HQ Contact Details
  - 2.3. MEDIA Contact Details
3. PROGRAMME AND CRITICAL DEADLINES

---

  - 3.1. Schedule for before the week of the Rally
  - 3.2. Schedule for the week of the Rally
4. ENTRY DETAILS

---

  - 4.1. Titles for which the Rally counts
  - 4.2. IMI ( National ) Titles for which the Rally counts
  - 4.3. Criteria for Acceptance of Entries
  - 4.4. ENTRY FEES
  - 4.5. International Competitor Assistance Package
5. SERVICEPARK

---

  - 5.1. ServicePark Layout
  - 5.2. Additional Information about the Service Parks
  - 5.3. Facilities
  - 5.4. Type of Surface
  - 5.5. Service Crew and Service Vehicle Registration
  - 5.6. Tire Service
6. RECONNAISSANCE

---

  - 6.1. Summary of present regulations and specific instructions valid for the event
  - 6.2. Registration for Reconnaissance
  - 6.3. Specific restrictions
7. MEDIA

---

  - 8.1. .Accreditation Procedure/Criteria and Deadline
  - 8.2. Contact Details
  - 8.3. Accreditation Form
  - 8.4. Media Centre Hours of Operation
  - 8.5. Radio Coverage
  - 8.6. TV Coverage
8. TWO-WAY RADIO COMMUNICATION AND MOBILE PHONES

---

  - 9.1. Application Procedure
  - 9.2. Contact details to person/authority in charge
  - 9.3. Application form
  - 9.4. Mobile Phone
10. FUEL

---

  - 10.1. Fuel/Refuelling Regulations
  - 10.2. Remote/additional refuel points
11. HOSPITALITY ARRANGEMENTS

---

  - 11.1. Contact Details for person in charge for hospitality arrangements
12. HOTEL ACCOMMODATION

---

  - 12.1. Contact Details for Reservations
  - 12.2. Form for Reservations
  - 12.3. List of Hotels
13. LIST OF USEFUL FACT AND SERVICES

---

  - 13.1. Accreditation Procedure/Criteria and Deadline



## RALLY GUIDE 1

- 13.2. Contact Details
- 13.3. Accreditation Form
- 13.4. Media Centre Hours of Operation :

### 14. SCRUTINEERING/SEALING AND MARKING

---

- 14.1. Scrutineering, Sealing and Marking
- 14.2. Location
- 14.3. Times / schedule
- 14.4. Preparations to be made before car is brought to scrutineering
- 14.5. Road book to Scrutineering from Rally HQ
- 14.6. Final scrutineering
- 14.7. Location Final Scrutineering

### 15. START PROCEDURE

---

- 15.1. Ceremonial Start
- 15.2. Start Leg 1

### 16. FINISH PROCEDURE

---

- 16.1. Location and time
- 16.2. Programme, Procedure and Instructions
- 16.3. Lay out of Finish area

### 17. PR ACTIVITIES

---

### 18. MEDICAL AND SAFETY SERVICES

---

Emergency number, list of hospitals, telephone numbers to police, pharmacies etc

## APPENDIX A

- A1. ITINERARY
- A2. Special Stage Description
- A3. RECONNAISSANCE SCHEDULE

## APPENDIX B : MAPS

- B1. HOST CITY/TOWN
- B2. ROUTE MAP
- B3. SPECIAL STAGES LEG 1
- B4. SPECIAL STAGES LEG 2

## APPENDIX C : LAYOUT

- C1. LAYOUT OF SCRUTINEERING AREA
- C2. LAYOUT OF CEREMONIAL START
- C3. LAYOUT OF SERVICE PARK
- C4. LAYOUT OF CEREMONIAL / PODIUM FINISH

## APPENDIX E : FORMS

- E1. ENTRY FORM

## APPENDIX F : MORE INFORMATION



## RALLY GUIDE 1

This document has no regulatory power, except if referred to specifically in the Supplementary Regulations or a Bulletin and therefore should be used as a guide only. For regulations please refer to the FIA Rally Championship General Prescriptions, the International Sporting Code, the IMI National Sporting Regulations and the event Supplementary Regulations and any Bulletin that may be issued.

[www.imi-sumut.or.id](http://www.imi-sumut.or.id)



## RALLY GUIDE 1

### 1. WELCOME & INTRODUCTION

Dear Rally Enthusiast !

On behalf of the INDONESIA RALLY 2013 organization, we would like to extend our warmest welcome to all visitors attending to the event. We want to ensure that as our most important customers you are provided with the highest possible level of event organization.

In this event, drivers from Indonesia and other countries will compete in North Sumatera in the INDONESIA RALLY 2013, Round 2 Tri Nations Rally Championship 2013, Round 2 National Rally Championship 2013 and North Sumatera Rally Championship 2013.

The World Rally Championship 1996 & 1997 stages was very attractive to compete and witnessing by the local community also its being by the local media.

Rally Championship in North Sumatera not a new issue, and with their hustle society and the developed infrastructures will be a committed host that will fully support the INDONESIA RALLY 2013.

If you need further information regarding the event, you are most welcome to contact the following :

Address of the Permanent Secretariat :

**PENGPROV. IMI - SUMUT**

Jl. Taruma No. 52

Medan 20112

Tel: +6261 452 0672

Fax: +6261 452 8821

North Sumatera – Indonesia

e-mail : [info\\_sekretariat@imi-sumut.or.id](mailto:info_sekretariat@imi-sumut.or.id)

website: [www.imi-sumut.or.id](http://www.imi-sumut.or.id)

All competitor inquires should be attention to:

Clerk Of Course

: Mr. Elwin Siregar

Mobile: +62 852 6262 2989

e-mail : [elwinsrg@gmail.com](mailto:elwinsrg@gmail.com)

Competitor Support Manager

: Mrs. Tina

Mobile: +62 811 606 436

e-mail : [info\\_sekretariat@imi-sumut.or.id](mailto:info_sekretariat@imi-sumut.or.id)

To all Competitors, Visitors and the Media, I hope your time in Medan, North Sumatera and your involvement with the Rally is enjoyable and successful sport event.

I look forward to welcoming you to the INDONESIA RALLY 2013.

Best regards,

Elwin Siregar

Clerk of The Course



## RALLY GUIDE 1

### INTRODUCTION

Indonesia is an adventure into a culturally fascinating and wonderfully scenic paradise. The world's largest archipelago stretches across the equator for more than 5,000 miles and 17,000 islands along the explosively volcanic and incredibly fertile "Ring of Fire".

This is the 4<sup>th</sup> most populous country in the world with over 210 million people from a multitude of ethnic groups, customs, religions and languages.

### THE CLIMATE

Indonesia has a largely equatorial climate tempered by trade winds. There are only two seasons, the dry season between April and October, and the rainy season from November to March. The rainfall varies from island to island and often from area to area within the island boundaries.

The average daily temperature in the lowlands is about 30 degrees Celsius and is considerably lower in the mountains.

### CLOTHING

Dress is normally casual and light clothing is advisable due to the hot, humid climate. Trousers or slacks and shirts are generally considered appropriate but a jacket and tie are required for formal occasions or when making official calls. For certain formal occasions, long-sleeved batik shirts are acceptable.

### THE LAND

Indonesia is the most volcanic country on earth with almost 4,500 volcanoes creating an incredibly fierce and impressive backbone to much of the archipelago. Five main islands and 30 smaller archipelagoes are home to the majority of the population. The main islands in order of size are; Kalimantan, Sumatera, Papua, Sulawesi and the country's most populated island, Java.

### THE FORMALITIES

All travelers to Indonesia must be in possession of passport valid for at least six months from date of arrival and have proof (tickets) of onward or return passage. The Government of Indonesia has issued a new regulation concerning the application of visas for foreign nationals to enter Indonesia. Free tourist visas are granted for a period of 30 days to nationals of Thailand, Malaysia, Singapore, Brunei Darussalam, Philippines, Hongkong Special Administration Region, Macao SAR, Chile, Morocco, Peru and Vietnam.

Since February, 2004, The Indonesian government has granted on arrival visas to nationals of United States, Australia, South Africa, Argentina, Brazil, Denmark, United Arab Emirates, Hungary, Finland, Great Britain, Italy, Canada, Norway, Japan, Germany, Poland, South Korea, France, Swiss, New Zealand and Taiwan.

Tourist visas for thirty days can be obtained from any Indonesian embassies or consulates. Two photographs are required and a small fee is charged.

### GETTING AROUND

An extensive transportation network provides access to all but the most secluded of places in Indonesia. Flying is by far the most convenient way of hopping across the archipelago with a choice of flights from airports in all provincial and district capitals.

Although flying can be quick and convenient it doesn't really provide some opportunities as traveling overland to experience and feel the quintessential spirit of Indonesia.

Trains are available throughout Java and in parts of Sumatera and are invariably enjoyable throughout ways to experience the essence of the country.

Buses are a convenient and relatively cheap way to travel across this fascinating country.

Cars and taxis can be hired of course, and provide perfect opportunities to get off the beaten track and explore independently.



# RALLY GUIDE 1

Indonesia has always been a seafaring nation and proudly boasts of the last remaining commercial sailing fleet the world. More than 3,000 traditional tall-mast sailing ships, reminiscent of an earlier time, still trade between the islands.

## CUISINE

Aromatic spices and a variety of hot chili peppers are the essence of most Indonesia dishes. Rice is an important part of the national diet for most of the archipelago, but in the eastern islands corn, sago, cassava and sweet potatoes are more common. The enormous wealth of the surrounding seas and oceans, as well as fresh water fisheries, provides an abundance of sea food which can be traditionally served in a number of exciting ways, including baked in banana leaves.

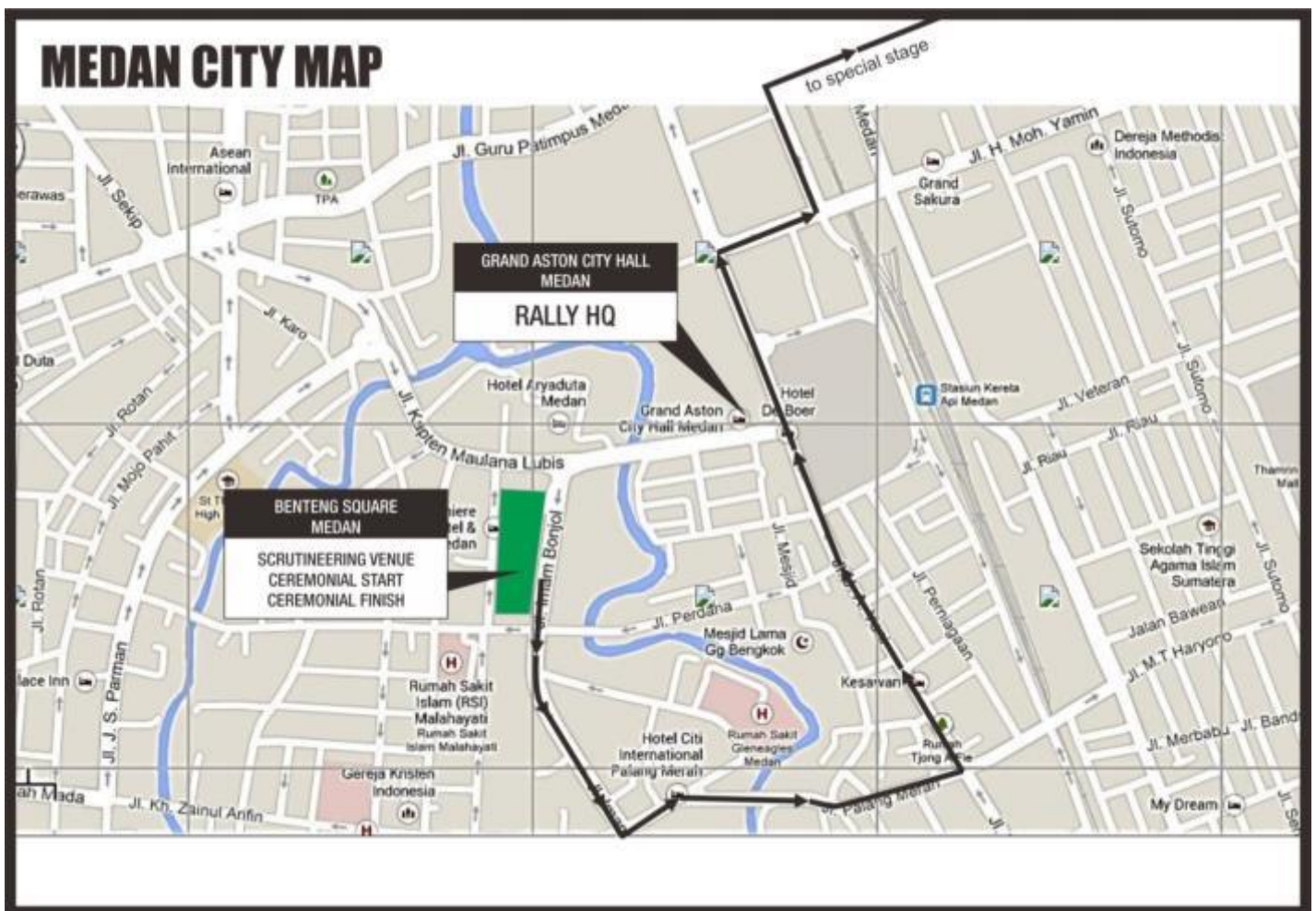



## RALLY GUIDE 1

### HOST CITY/TOWN

#### MEDAN CITY

Welcome to Medan

**Medan** (Indonesian pronunciation: [me'dan]; Indonesian: Kota Medan) is the capital of the North Sumatra province in Indonesia. Located on the northern coast, Medan is the fourth largest city in Indonesia (behind Jakarta, Surabaya, and Bandung), and the largest Indonesian city outside Java. The city is bordered by the Deli Serdang Regency to the east, south and west, and the Strait of Malacca to the north. It is close to the volcano Sinabung, which just erupted in Sept 2013 after a 400 year dormant state.

#### HISTORY

Medan started as a village called Kampung Medan (Medan Village). Kampung Medan was founded by Guru Patimpus around the 1590s. Because Kampung Medan sits on Tanah Deli (Land of Deli), Kampung Medan is also referred as Medan-Deli. The original location of Kampung Medan is an area where the Deli River meets the Babura River.

Based on the diary of the Portuguese merchant in early 16th century, it stated that the name of Medan was actually derived from Medina which is actually a holy city in the western of Saudi Arabia. However, other sources indicated that the name of Medan actually came from IndianHindi language word "Maidan" meaning "ground" or "land"(like in Pragati Maidan in Delhi). One of the Karo-Indonesia dictionary written by Darwin Prinst SH published in 2002 wrote that Medan could also be defined as "recover" or "be better".

The first inhabitants of Medan came from the Malays of the Malay Peninsula, the Mandailings from the South Tapanuli Regency and the Karonese who originated from the Karo Highlands. It was not until the Sultan of Aceh, Sultan Iskandar Muda, sent his warlord, Gocah Pahlawan Laksamana Khoja Bintan, to be the Sultanate of Aceh's representative in Tanah Deli, that the Sultanate of Deli started to grow. This growth stimulated growth in both the population and culture of Medan. In the second year reign of Sultan Deli (between 1669–1698), there was a cavalry battle in Medan.

Medan did not experience significant development until the 1860s, when the Dutch colonialists began clearing the land for tobacco plantations. Medan quickly became a center of government and commercial activity, dominating development of Indonesia's western region.

The Dutch governed Tanah Deli from 1658, after Sultan Ismail, ruler of the Siak Sultanate, yielded some of his once-ruled land, Deli, Langkat, and Serdang. In 1915 Medan officially became the capital of North Sumatra Province, and officially a city in 1918.

Currently much of Medans historic architecture from the colonial era is rapidly being demolished to make way for modern buildings (malls, garages, etc.).

There are many old buildings in Medan that still retain their Dutch architecture. These include the old City Hall, the central Post Office, the Tirtanadi Water Tower, which is Medan City's icon, and Titi Gantung (a bridge over the railway).

There are several historic places such as Maimun Palace (Istana Maimun) built in years 1887–1891, where the Sultan of Deli still lives (the Sultan no longer holds any official power), and the





## RALLY GUIDE 1

Great Mosque (Masjid Raya) of Medan built in 1906 in the Moroccan style by the Dutch architect A.J. Dingemans.<sup>[3]</sup>

Since 2005, a catholic temple, in Indo-Mogul style, devoted to Graha Maria Annai Velangkanni (Our Lady of Good Health), is built in Medan. This particular Saint knows its origin with an apparition in the 17th century in India. The temple is an important building, of two stories and a small tower of seven storeys in Indonesian style, that already attracts attention from the main road (it is situated in the small road Jl. Sakura III besides Jl. TB Simatupang). It is already the second most important pilgrimage place in Asia.

### DEMOGRAPHY

The city is Indonesia's fourth most populous after Jakarta, Surabaya, and Bandung, and Indonesia's largest city outside of Java island. Much of the population lies outside its city limits, especially in Deli Serdang Regency. The official Metropolitan area (*Wilayah Metropolitan Medan*) contained 4,144,583 inhabitants in 2010.

The city has diverse communities, reflecting its history. However, The Mandailings also live here in big numbers and working at the most strategic government position. In addition, there is a large ethnic Javanese community, largely made up of the descendants of people transported from Java in the last century to be employed as contract workers at various plantations in North Sumatra. They are usually known as Jadel (Jawa Deli/Deli Javanese) or Jakon (Jawa Kontrak/Contract Javanese), and, with other Javanese communities in Sumatra, Pujakesuma (Putra Jawa Kelahiran Sumatera/Sumatra-born Javanese). Their presence in Medan can be marked from various Javanese toponymies in Medan, such as Harjosari, Sarirejo, Sidodadi, Sidomulyo, Sidorame, Sidorejo, Sitirejo, Sudirejo, Tanjungrejo, Tanjungsari, Tegalrejo, Tegalsari, etc.

A highly visible component of Medan's population is the large number of Chinese, who are very active in the business sector, and unlike the ethnic Chinese in many other parts of Indonesia, they continue to speak Hokkien. The city also host a sizable community of Tamil descendants who are commonly known as *keling*. A well-known Tamil neighbourhood is *Kampung Keling*. In addition to Indonesian, Malay, Mandailing, Minangkabau, Karo, Javanese, Hokkien, Tamil, Aceh, and English are spoken.

Due to rapid growth in the its economy, the increased demand for electricity is under supplied by the local Power Company. A shortage of electricity supply forced the authority to regularly shut-off power among the areas in the city for several hours a day.

### LANDMARKS

There are many old buildings in Medan that still retain their Dutch architecture. These include the old City Hall, the central Post Office, the Tirtanadi Water Tower, which is Medan City's icon, and Titi Gantung (a bridge over the railway).

There are several historic places such as Maimun Palace (Istana Maimun) built in years 1887–1891, where the Sultan of Deli still lives (the Sultan no longer holds any official power), and the Great Mosque (Masjid Raya) of Medan built in 1906 in the Moroccan style by the Dutch architect A.J. Dingemans.<sup>[3]</sup>

Since 2005, a catholic temple, in Indo-Mogul style, devoted to Graha Maria Annai Velangkanni (Our Lady of Good Health), is built in Medan. This particular Saint knows its origin with an apparition in the 17th century in India. The temple is an important building, of two stories and a small tower of seven storeys in Indonesian style, that already attracts attention from the main road (it is situated in the small road Jl. Sakura III besides Jl. TB Simatupang). It is already the second most important pilgrimage place in Asia.



## RALLY GUIDE 1

### TRANSPORTATION

The new Kuala Namu International Airport (KNO) which opened to public on July 25, 2013 is the latest landmark and pride to people of Medan. This new most modern airport is a replacement of the old Polonia Airport. Unlike the old Polonia Airport which located in the heart of the city, this new airport is located approx.39 km from downtown. Taking the train to the Kualanamu International Airport is the easiest and fastest (37 minutes) way at the moment and it cost Rp.80,000 one way. The train schedule from Medan to Kualanamu International Airport is: 03.55; 04.50; 06.15; 08.20; 11.10; 13.45; 15.15; 17.15; 19.20; and 20.00 The train schedule from Kualanamu International Airport to Medan city is: 05.05; 06.30; 08.00; 09.25; 12.25; 14.45; 16.25; 18.30; 20.45; and 24.15. The train from Kualanamu International Airport to Medan city is about 45 minute . Train ticket can be paid in cash, debit/credit card of some national banks, and Visa. Taxi transfers will cost you about Rp150,000 per car and only special taxi with sticker can enter the airport. The official taxi companies serving the airport are Puskopau, Blue Bird, Kokapura, Express, Karsa, Matra and Nice; please be aware of taxis without sticker, although have the same brands with the sticker taxis. Air-conditioned "Damri" buses departs every 15 minutes to the airport from 05:00 to 23:00. There are two bus services serving the Airport-Medan route: Airport-Medan Fair (Rp15,000) and Airport-Amplas (Rp10,000). Taxi and bus will take 60 to 90 minutes from Medan to the airport, because there are several traffic jam locations. for further information please see

One of the unique features of Medan are the motorized pedicab that are found almost everywhere. Unlike traditional becaks, a motorized becak can take its passenger anywhere in the city. The fare of riding a becak is relatively low and is usually negotiated beforehand.

There are also more common means of transport like taxis and minibuses, known as *sudako*.

Railroad tracks connect Medan to Binjai and Tanjungpura to the northwest, to port of Belawan to the north, to Tebing Tinggi and Pematang Siantar to the southeast, and also Rantau Prapat among other cities. The largest train station in Medan is Medan Station. There are also smaller stations in Medan, such as Medan Pasar, Pulu Brayan, Titi Papan, and Labuhan, and Belawan. Titi Papan and Pulu Brayan only serve as the stop for freight trains carrying oil palm and petroleum.

The seaport of Belawan is about 20 km to the north. Polonia International Airport is located in the heart of the city, because of its close proximity to the city center, the government is currently imposing a ban on constructing high rise buildings. Kuala Namu International Airport is a new airport under construction and is due to replace Polonia in mid-2013. The new airport will boast a capacity of 8.1 million passengers a year.<sup>[4]</sup>

A toll highway connects Medan to Belawan and Tanjungmorawa. A plan for the extension of this highway to Kuala Namu International Airport, Tebing Tinggi and to Binjai has been completed, and the central government is currently seeking investors to build the extension.

### MEDIA

The TVRI Medan (state-owned) and Deli TV (private) are the two local television stations in Medan. Several local newspapers are running in the city with *Harian Mimbar Umum* as the oldest one. Other popular newspapers include *Harian Waspada*, *Harian Analisa*, *Berita Sore*, *Harian Global*, *Harian Medan Bisnis*, *Posmetro Medan*, *Suara Indonesia Baru*, dan "*Tribun Medan*".



## RALLY GUIDE 1

### RALLY INDONESIA

Year	Name	Winner	Co-Driver	Car	Rally Classification
1986	11th Rally Indonesia / Trans Sumatra Rally	<a href="#">Beng Soeswanto</a>	<a href="#">Adiguna Sutowo</a>	<a href="#">Ford Laser TX-3</a>	<a href="#">International</a>
1987	12th Rally Indonesia	<a href="#">John Bosch</a>	<a href="#">Kevin Gourmley</a>	<a href="#">Audi Quattro</a>	<a href="#">International</a>
1988	13th Rally Indonesia	<a href="#">Beng Soeswanto</a>	<a href="#">Adiguna Sutowo</a>	<a href="#">Mitsubishi Lancer 1600 GSR</a>	<a href="#">International</a>
1989	14th Rally Indonesia	<a href="#">Ross Dunkerton</a>	<a href="#">Mej Zainuddin</a>	<a href="#">Mitsubishi Galant VR-4</a>	<a href="#">International</a>
1990	15th Rally Indonesia	<a href="#">Kenjiro Shinozuka</a>	<a href="#">John Meadows</a>	<a href="#">Mitsubishi Galant VR-4</a>	<a href="#">International</a>
1991	16th Bank Utama Rally Indonesia	<a href="#">Ross Dunkerton</a>	<a href="#">Fred Gocentas</a>	<a href="#">Mitsubishi Galant VR-4</a>	<a href="#">International</a>
1992	17th <a href="#">Bentoel</a> Rally Indonesia	<a href="#">Ross Dunkerton</a>	<a href="#">Fred Gocentas</a>	<a href="#">Mitsubishi Galant VR-4</a>	<a href="#">International</a>
1993	18th Bank Utama Rally Indonesia	<a href="#">Possum Bourne</a>	<a href="#">Rodger Freeth</a>	<a href="#">Subaru Legacy RS</a>	<a href="#">International</a>
1994	19th Bank Utama Rally Indonesia	<a href="#">Kenneth Eriksson</a>	<a href="#">Staffan Parmander</a>	<a href="#">Mitsubishi Lancer Evolution II</a>	<a href="#">WRC Candidate</a>
1995	20th Bank Utama Rally Indonesia	<a href="#">Colin McRae</a>	<a href="#">Derek Ringer</a>	<a href="#">Subaru Impreza 555</a>	<a href="#">WRC Candidate</a>
<a href="#">1996</a>	21st Bank Utama Rally Indonesia	<a href="#">Carlos Sainz</a>	<a href="#">Luis Moya</a>	<a href="#">Ford Escort RS Cosworth</a>	<a href="#">WRC</a>
<a href="#">1997</a>	22nd Rally Indonesia	<a href="#">Carlos Sainz</a>	<a href="#">Luis Moya</a>	<a href="#">Ford Escort WRC</a>	<a href="#">WRC</a>
2000	<a href="#">Gudang Garam</a> Rally Indonesia	<a href="#">Karamjit Singh</a>	<a href="#">Allen Oh</a>	<a href="#">Proton PERT</a>	<a href="#">National</a>
2001	<a href="#">Gudang Garam</a> Rally Indonesia	<a href="#">Chandra Alim</a>	<a href="#">Prihatim Kasiman</a>	<a href="#">Mitsubishi Lancer Evolution VI</a>	<a href="#">National</a>
2002	25th <a href="#">Gudang Garam</a> International Rally Indonesia	<a href="#">Rifat Sungkar</a>	<a href="#">Mohamad Herkusuma</a>	<a href="#">Mitsubishi Lancer Evolution IV</a>	National
2003	26th <a href="#">Gudang Garam</a> International Rally Indonesia	<a href="#">Rifat Sungkar</a>	<a href="#">Karel Hailatu</a>	<a href="#">Mitsubishi Lancer Evolution IV</a>	National
2004	27th <a href="#">Gudang Garam</a> International Rally Indonesia	<a href="#">Hery Agung</a>	<a href="#">Hade Mboi</a>	<a href="#">Mitsubishi Lancer Evolution VI</a>	National
<a href="#">2005</a>	28th <a href="#">Gudang Garam</a> International Rally Indonesia	<a href="#">Jussi Välimäki</a>	<a href="#">Jarkko Kalliolepo</a>	<a href="#">Mitsubishi Lancer Evolution VIII</a>	<a href="#">APRC</a>
<a href="#">2006</a>	29th <a href="#">Gudang Garam</a> International Rally Indonesia	<a href="#">Toshihiro Arai</a>	<a href="#">Tony Sircombe</a>	<a href="#">Subaru Impreza WRX N12</a>	<a href="#">APRC</a>
<a href="#">2007</a>	30th <a href="#">Gudang Garam</a> International Rally Indonesia	<a href="#">Jussi Välimäki</a>	<a href="#">Jarkko Kalliolepo</a>	<a href="#">Mitsubishi Lancer Evolution IX</a>	<a href="#">APRC</a>
<a href="#">2008</a>	31st <a href="#">Gudang Garam</a> International Rally Indonesia	<a href="#">Gaurav Singh Gill</a>	<a href="#">Jagder Singh</a>	<a href="#">Mitsubishi Lancer Evolution IX</a>	<a href="#">APRC</a>



# RALLY GUIDE 1

<a href="#">2009</a>	32nd Gudang Garam International Rally Indonesia	<a href="#">Cody Crocker</a>	<a href="#">Ben Atkinson</a>	<a href="#">Mitsubishi Lancer Evolution IX</a>	<a href="#">APRC</a>
----------------------	---	------------------------------	------------------------------	--	----------------------

## NORTH SUMATRA's PREVIOUS RALLY

- 1975 I.M.S.U Trans Sumatra Rally
- 1986 Sony Rally of Indonesia (Int / Nat )
- 1987 Sony Rally of Indonesia (Int / Nat)
- 1989 Gudang Garam Rally Indonesia (Int / Nat)
- 1990 Gudang Garam Rally Indonesia (Int / Nat)
- 1991 Gudang Garam Rally Indonesia (Int / nat)
- 1992 Bentoel Rally Indonesia (Int / Nat)
- 1993 Bentoel Rally Indonesia (Int / Nat)
- 1994 Bentoel Rally Indonesia (APRC / Nat)
- 1994 Rally Sumatera Utara ( Nat)
- 1995 Bentoel Rally Indonesia (APRC / Nat)
- 1996 Timor Rally Indonesia (Nat)
- Bank Utama Rally Indonesia (WRC / APRC / Nat)
- 1997 Gudang Garam Rally Indonesia (WRC / APRC / Nat)
- 2000 Gudang Garam Rally Indonesia (APRC / Asian Zone / Nat)
- 2005 Bhayangkara - Gudang Garam International Rally Indonesia (Nat)
- 2006 Gudang Garam International Rally Indonesia (Int / Nat)
- 2007 Gudang Garam International Rally Indonesia (Int / Nat)
- 2008 Gudang Garam International Rally Indonesia (Int / Nat)
- 2009 Gudang Garam International Rally Indonesia (Int / Nat)
- 2011 Langkat Rally (Nat)
- Medan Rally (Nat)
- North Sumatra Rally (Nat)
- 2012 Langkat Rally (Nat)
- Sergei Rally (Nat)
- Medan Rally (Nat)

**Note:** Int – FIA International Rally      Nat – IMI National Rally Championship



TRI-NATIONS CUP - OVERALL											
CUMULATIVE - ROUNDS 1 to 1											
	Driver	For Round	For Leg 1	For Leg 2	Total		Co-Driver	For Round	For Leg 1	For Leg 2	Total
1	Daniel Palau	10.0	3.0	2.0	15.0	1	Thierry Song	10.0	3.0	2.0	15.0
2	Karamjit Singh	8.0	1.0	3.0	12.0	2	Jagdev Singh	8.0	1.0	3.0	12.0
3	Benny Lautan	6.0	0.0	0.0	6.0	3	Edwin Alhar	6.0	0.0	0.0	6.0
4	Abdul Ghaffar Alias	5.0	0.0	0.0	5.0	4	Mohd Rafidi Wahidudin	5.0	0.0	0.0	5.0
5	Chaiyan Longton	4.0	0.0	0.0	4.0	5	Nipaporn Asaisart	4.0	0.0	0.0	4.0
6	Sori Mulia Siregar	3.0	0.0	0.0	3.0	6	Riswansyah Sipaynne	3.0	0.0	0.0	3.0
7	Tomohide Hasegawa	2.0	0.0	0.0	2.0	7	Osamu Yoda	2.0	0.0	0.0	2.0
8	Brian Green	0.0	2.0	0.0	2.0	8	Fleur Pedersen	0.0	2.0	0.0	2.0
9	Nandakumar Puspanathan	1.0	0.0	0.0	1.0	9	Matthew Palmer	1.0	0.0	0.0	1.0
10	Muhammad Rafiq Udhaya	0.0	0.0	1.0	1.0	10	Maruthi Ariokiasamy	0.0	0.0	1.0	1.0



## RALLY GUIDE 1



### POINT KEJURNAS RALLY 2013

#### UMUM DRIVER

	NAMA	PENGPROV	Put 1	Put 2	Put 3	Total Point	Run
1	AKBAR HADIANTO	SLS	20			20	1
2	Priamanaya Djan	DKI	16			16	1
3	ERWIN MANCHA	DKI	13			13	1
4	MBN Boyke	DKI	10			10	1
5	SUBHAN AKSA	SLS	8			8	1
6	Rizki Prayoga H A	KLS	6			6	1
7	EDDY WS	SMU	4			4	1
8	Andry Tanujaya	DKI	3			3	1

#### UMUM NAVIGATOR

	NAMA	PENGPROV	Put 1	Put 2	Put 3	Total Point	Run
1	Arianto Sjarief	DKI	20			20	1
2	Yudi Herwanto	DKI	16			16	1
3	Maman Aruman	JBR	13			13	1
4	Ario Danu	DKI	10			10	1
5	Hade Mboi	SLS	8			8	1
6	Kukuh Prihastowo	KLS	6			6	1
7	Syariful Adil D	SMU	4			4	1
8	Ade Ramadhan	DKI	3			3	1

#### GR2 DRIVER

	NAMA	PENGPROV	Put 1	Put 2	Put 3	Total Point	Run
1	EDDY WS	SMU	10			10	1
2	Andry Tanujaya	DKI	6			6	1
3							

#### GR2 NAVIGATOR

	NAMA	PENGPROV	Put 1	Put 2	Put 3	Total Point	Run
1	Syariful Adil D	SMU	10			10	1
2	Ade Ramadhan	DKI	6			6	1
3							

#### Jeep1 DRIVER

	NAMA	PENGPROV	Put 1	Put 2	Put 3	Total Point	Run
1	Reza Pahlevi	SLS	10			10	1
2	M Affan Ali	SLS	6			6	1
3	Indra Rizky S	SLS	4			4	1
4	H Irfan	SLS	3			3	1
5	Frans Yohannis	SLS	2			2	1
6	Alan Nizar	SLS	1			1	1

#### Jeep1 NAVIGATOR

	NAMA	PENGPROV	Put 1	Put 2	Put 3	Total Point	Run
1	A Zulfadly	SLS	10				1
2	Indra	SLS	6				1
3	Rexi Arianto	SLS	4				1
4	Indar	SLS	3				1
5	Muknaidar Gasba	SLS	2				1
6	Dg Nai	SLS	1				1

#### TEAM CLUB

	TEAM	Put 1	Put 2	Put 3	Total Point
1	FBRT Motor Sport	36			36
2					0
3					

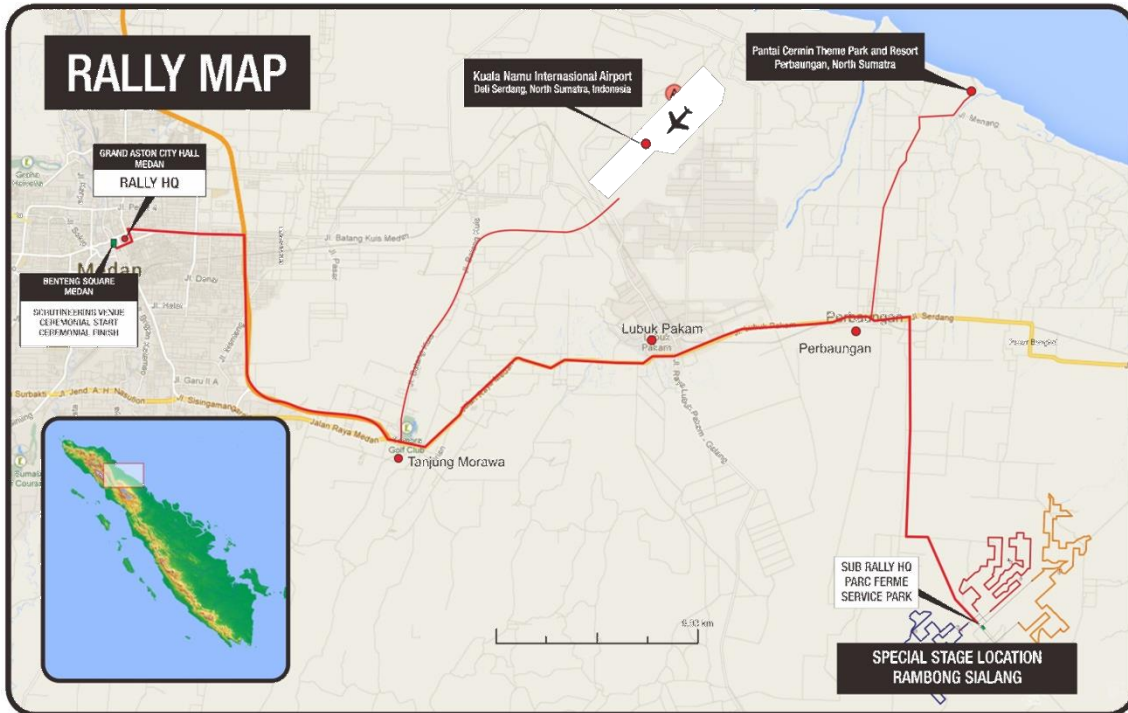

**EVENT OVERVIEW**

Total Distance :	276.26 km
No of Stages :	9
Stage Distance :	188.38 km
Stage Surface	All Gravel
Longest Stage	SS 1/4 Rambong Sialang A - 22.63 km
Shortest Stage	SS 8 Rambong Sialang C-Reverse - 18.83 km
Close Of Entries	Tuesday, 8 October 2013
Stage In Darkness	Nil
Sunrise	06:00 hrs
Sunset	18:00 hrs
Sevice Park	Rambong Sialang Service Park
Parc Ferme	Rambong Sialang Parc Ferme
Rally HQ Location	Grand Aston City Hall, Jl. Balai Kota No. 1, Medan
Rally Headquarters Opens	09:00 hrs, Tuesday, 8 October 2013
Press Room Opens	09:00 hrs, Wednesday, 8 October 2013
Reconnaissance	08:00 – 17:30 hrs, Thursday & 07:00 – 10:00 hrs, Friday
Shakedown	Nil
Competitor Briefing	14:30 hrs, Deli Room Medan Club
Scrutineering	Benteng Square, Medan
Ceremonial Start	Benteng Square, Medan
Start Order Published	14:00 hrs, Friday
Publication of Provisional Result	16:00 hrs, Sunday
Ceremonial Finish	Benteng Square, Medan
Prize Giving	Benteng Square, Medan
Information & Result	<a href="http://www.imi-sumut.or.id">www.imi-sumut.or.id</a>



## RALLY GUIDE 1

### 2. ORGANISER'S CONTACT DETAILS

Below are the faces of the INDONESIA RALLY 2013, Round 2 TRI NATIONS RALLY Championship 2013, Round 2 National Rally Championship 2013 and North Sumatra Rally Championship 2013, personnel you will most likely be dealing with you



**Mrs. TINA**  
COMPETITOR SUPPORT MANAGER  
Mobile: +62 811 606 436  
e-mail: [info\\_sekretariat@imi-sumut.or.id](mailto:info_sekretariat@imi-sumut.or.id)



**Mr. ELWIN SIREGAR**  
CLERK OF THE COURSE  
Mobile: +62 852 6262 2989  
e-mail: [elwinsrq@gmail.com](mailto:elwinsrq@gmail.com)

#### 2.1. Permanent contact Details

##### 2.1.1. Permanent Postal and Visitors Address

###### Rally Secretariat

Office Address :

**PENGPROV. IMI - SUMUT**

Jl. Taruma No. 52

Medan 20112

North Sumatera – Indonesia

Hours of Business :

09:00 – 17:00 hrs, Monday to Friday

##### 2.1.2. Phone and Fax Numbers

Telephone : +6261 452 0672

Fax : +6261 452 8821

##### 2.1.3. Email and Internet addresses

e-mail : [info\\_sekretariat@imi-sumut.or.id](mailto:info_sekretariat@imi-sumut.or.id)

website : [www.imi-sumut.or.id](http://www.imi-sumut.or.id)

#### 2.2. Rally HQ Contact Details

##### 2.2.1. Rally Headquarters Address :

Grand Aston City Hall

Balaikota Underground

Lobby Lower

Jl. Balai Kota No. 1

Medan - 20112

North Sumatera, Indonesia.



## RALLY GUIDE 1

### 2.2.2. Rally HQ, Secretariat Hours of Operation :

- Tuesday, 8 October 09:00 - 20:00 hrs
- Wednesday, 9 October 09:00 - 20:00 hrs
- Thursday, 10 October 09:00 - 20:00 hrs
- Friday, 11 October 07:00 - 21:00 hrs
- Saturday, 12 October 07:00 - 20:00 hrs
- Sunday, 13 October 06:00 - 21:00 hrs
- Monday, 14 October 09:00 - 12:00 hrs

## 2.3. MEDIA Contact Details

### 2.3.1. Contact Details to Media Relation Officers :

- **Mr. Armansyah Taher**  
Mobile Phone : +62 821 6151 1611  
e-mail : [armanth70@gmail.com](mailto:armanth70@gmail.com)

### 2.3.2. Accreditation Desk

The Accreditation Desk is located in the Rally Headquarters

### 2.3.3. Media Room

The Media Room and Accreditation Office are located in the Rally Headquarters.





## RALLY GUIDE 1

### 3. PROGRAMME AND CRITICAL DEADLINES

#### 3.1. Schedule for before the week of the Rally

Saturday, 16 September		
09:00 hrs	Entries open, Pre Event Information and Supplementary Regulation published	Rally Secretariat

#### 3.2. Schedule for the week of the Rally

Tuesday, 8 October		
09:00 hrs	Rally Headquarters and Official Notice Board opens  Road Books and Route Maps available for Collection at Rally Secretariat	<b>Rally Headquarters :</b> Grand Aston City Hall Balaikota Underground Lobby Lower Jl. Balai Kota No. 1 Medan - 20112 North Sumatera, Indonesia.
09:00 – 17:00 hrs	Competitor, Reconnaissance and Service Vehicle & Crew registration	Rally HQ
	Collection of Materials and Documents Administrative Checks	Rally HQ

Wednesday, 9 October		
10:00 hrs	Media Accreditation & Press Room open	Rally HQ
09:00 – 17:00 hrs	Competitor, Reconnaissance and Service Vehicle & Crew registration	Rally HQ
	Collection of Materials and Documents Administrative Checks	Rally HQ
10:00 hrs	Media Accreditation & Press Room open	Rally HQ

Thursday, 10 October		
08:00 hrs	Start of Reconnaissance	See Reconnaissance Schedule
09:00 – 17:00 hrs	Administrative Checks	Rally HQ
17:00 hrs	<u>Publication of</u> Scrutineering Schedule Entry List Final Service Bay allocation Optional Advertising space	Rally HQ (Official Notice Board)



## RALLY GUIDE 1

### Friday, 11 October

07:00 – 10:00 hrs	Start of Reconnaissance	See Reconnaissance Schedule
08:00 – 12:00 hrs	Scrutineering and Component Sealing & Marking	Benteng Square, Medan,
13:30 hrs	First Meeting of the Stewards Sub Rally HQ	Rally HQ
14:00 hrs	<u>Publication</u> of List of Crews Eligible to Start, Ceremonial Start List and StartList for Leg 1	Rally HQ (Official Notice Board)
14:30 hrs	Competitor Briefing	Deli Room Medan Club
15:00 hrs	Pre-Rally Press Conference	Deli Room Medan Club
16:00 hrs	Cars report to Pre-Start Park (Limit time)	Benteng Square, Medan
16:00 hrs	Service Area available for Competitors	Rambong Sialang
16:30 hrs	Ceremonial Start	Benteng Square, Medan
19:30 hrs	Dinner & Welcome Party hosted by The State Government of North Sumatra	NorthSumatera Governor's Residence

### Saturday, 12 October

09:00 hrs	Start of Leg 1 (Official Start)	Rambong Sialang Parc Ferme
17:05 hrs	Finish Leg 1	Rambong Sialang Parc Ferme
18:30 hrs	<u>Publication</u> of Partial Unofficial Classifications (Leg 1)	Sub Rally HQ (Official Notice Board)
19:00 hrs	<u>Publication</u> of Start List for Leg 2	Sub Rally HQ (Official Notice Board)

### Sunday, 13 October

08:30 hrs	Start Leg 2	Rambong Sialang Parc Ferme
14:00 hrs	End of Rally, Parc Ferme	Rambong Sialang Parc Ferme
14:15 hrs	Final Scrutineering	Rambong Sialang Parc Ferme
16:00 hrs	<u>Publication</u> of Provisional	Sub Rally HQ



## RALLY GUIDE 1

	Final Classification	Rambong Sialang (Official Notice Board)
16:30 hrs	<u>Publication</u> of Final Official Classification	Rally HQ Rambong Sialang (Official Notice Board)
19:30 hrs	Ceremonial Finish	Benteng Square, Medan
20:15hrs	Post Event Press Conference	Benteng Square, Medan

### Monday, 14 October

12:00 hrs	Press Room closes	Rally HQ, Medan
17:00 hrs	Rally Headquarters closes	Rally HQ, Medan

### RALLY SECRETARIAT & OFFICIAL NOTICE BOARD

**Location:** PENGPROV. IMI – SUMUT, Jl. Taruma No. 52, Medan  
**Time:** Office hours 09:00 – 18:00 hrs

### RALLY HEADQUARTERS & OFFICIAL NOTICE BOARD

**Location:** Grand Aston City Hall  
 Balaikota Underground Lobby Lower  
 Jl. Balai Kota No. 1 Medan - 20112  
 North Sumatera – Indonesia  
**Time:** Tuesday till Monday, 8 - 14 October 2013

### SUB RALLY HEADQUARTERS & OFFICIAL NOTICE BOARD

**Location:** Rambong Sialang Service Park, Perkebunan Lonsum  
**Time:** Saturday till Sunday, 12 – 13 October 2013

### MEDIA CENTRE & MEDIA NOTICE BOARD

**Location:** Rally HQ, tba, Medan  
**Time:** Tuesday, 8 October till Monday, 8 – 14 October 2013

**Location:** Sub Rally HQ, Rambong Sialang Service Park  
**Time:** Saturday till Sunday, 12 – 13 October 2013



# RALLY GUIDE 1

## 4. ENTRY DETAILS

### 4.1 Tri Nation's Rally titles for which the Rally counts

- 2013 Tri Nation's Rally Championship for Driver & Co-driver of TN 1
- 2013 Tri Nation's Rally Championship for Driver & Co-driver of TN 2
- 2013 Tri Nation's Rally Championship for Driver & Co-driver of TN 3

### 4.2 IMI (National) Titles for which the Rally counts

- 2013 National Rally Championship for Driver & Co-driver
- 2013 National Rally Championship for Driver & Co-driver of GR.2
- 2013 National Rally Championship for Best Driver & Co-driver of N15
- 2013 National Rally Championship for Best Non Seeded Driver & Co-driver of N15
- 2013 National Rally Championship for Best Driver & Co-driver of S
- 2013 National Rally Championship for Best Driver & Co-driver of J
- 2013 National Rally Championship for Club Team

### 4.3 North Sumatra Region titles for which the Rally counts

- 2013 North Sumatra Rally Championship Overall
- 2013 North Sumatra Rally Championship Overall for Non Seeded
- 2013 North Sumatra Rally Championship of Group Gr2
- 2013 North Sumatra Rally Championship for Non Seeded of N15
- 2013 North Sumatra Rally Championship of Class Gr2 / 2
- 2013 North Sumatra Rally Championship of Class Gr2 / 1
- 2013 North Sumatra Rally Championship of Group S
- 2013 North Sumatra Rally Championship of Class J2
- 2013 North Sumatra Rally Championship of Class J1

### 4.4 Criteria for Acceptance of Entries

The maximum number of entries is 50. If more than 50 entries are received, the Organizer reserves the right to decide which entries will be accepted.

All competitor accounts must be settled prior to the close of Administrative Checks to be eligible for scrutineering on Friday, 11 October 2013.

### 4.5 ENTRY FEES

ENTRY FEES	Privateer	Non Privateer
<b>Sedan Group A / N</b>	Rp 4.000.000,-	
<b>Sedan Non Group N</b>		
<b>Group J / S</b>	Rp. 2.000.000,-	
<b>INCLUDE</b>		
<input type="checkbox"/> 2 (two) Competitors ID	<input type="checkbox"/>	<input type="checkbox"/>
<input type="checkbox"/> 1 (one) Rally Guide 2 Book	<input type="checkbox"/>	<input type="checkbox"/>
<input type="checkbox"/> 1 (one) set of Road Books	<input type="checkbox"/>	<input type="checkbox"/>
<input type="checkbox"/> 1 (one) Supplementary Regulations Book	<input type="checkbox"/>	<input type="checkbox"/>
<input type="checkbox"/> 1 (one) unit Service Bay (5 X 10 m), in the Service Park	<input type="checkbox"/>	<input type="checkbox"/>
<input type="checkbox"/> 1 (one) Service Vehicle Registrations: 1 (one) Service Vehicle Plate, 4(four) Service Crew ID, 1 (one) Service Books	<input type="checkbox"/>	<input type="checkbox"/>



## RALLY GUIDE 1

<b>ADDITIONAL ENTRY FEE</b>	
<b>Without the optional advertising proposed by the Organizers</b>	<b>Rp 3,000,000</b>
<b>SERVICE &amp; AUXILIARY VEHICLE ENTRY FEE</b>	Rp 400,000
<b>INCLUDE</b>	
- 1 (one) Service / Auxilliary Plate	
- 1 (one) Service Books	
- 4 (four) Service Crew ID	
<b>1 (one) Service Crew ID</b>	Rp 100,000
<b>SERVICE TENT (Sarnafil Tent 5x5m)</b>	-
- 1 (one) unit Area Service size (5 X 5 m) include area (5 x 5 m) Service Vehicle parking for 2 (two) days.	
<b>INCLUDE</b>	
- 1 (one) table	
- 4 (four) chair	
- 1 (one) lamp	
<b>SERVICE TENT (regular tents 4x6m)</b>	Rp 1.000,000
- 1 (one) unit Area Service size (4 X 6m) include (3 x 5 m) Service Vehicle area parking for 2 (two) days.	
<b>INCLUDE</b>	
- 1 (one) table	
- 4 (four) chair	
- 1 (one) lamp	
<b>SERVICE AREA</b>	Rp 300,000
-1 (one) unit Service Bay (5 X 5m) include (3 x 5 m) Service Vehicle parking area for 2 (two) days.	
<b>MANAGER SET</b>	Rp 300,000
Receive:	
- 1 one) Manager ID	
- 1 (one) set Road Book	
- 1 (one) Supplementary Regulations	
<b>CHANGE OF DRIVER OR CO DRIVER</b>	Rp 500,000
Change of the crew member after the entry list issued, before the scrutineering	
<b>BEYOND SCRUTINEERING SCHEDULE / LATE</b>	Rp. 200.000
<b>CLUB TEAM ENTRIES</b>	Rp. 500.000
At the latest Friday, October 11, 2013, 14:00 hrs	



## RALLY GUIDE 1

### Payment Details

Fee payments can also be done by transfer through the Bank Account Committee:

Account : **PENGDA IMI SUMUT**  
No.Account : **383 0633 633**  
Bank : **Bank Central Asia (BCA)**

After transfer, the registrar immediately sent along with a description Data Transfer, Name of Entries, Vehicles, Group/ Class and payment allocation details.

## 5. SERVICEPARK

### 5.1. Service Park Layout

A diagram of the layout of the Service Park is included in **Appendix C**.

### 5.2. Additional Information about the Service Parks

#### RAMBONG SIALANGSERVICE PARK

The FIA Service Regulation require are refueling to be done in the refuel zones established immediately after the exit from the Service Parks. The Organizers design the itinerary with more advantages to the logistic flow of the participant as providing only one Service Park, Located  $\pm$  60 km South East of Rally Headquarters

The Organizers will providing competitors with access to the Rambong Sialang Service Park, Takalar, featuring under cover facilities and additional space to accomodated Service Vehicle, Trucks and Auxiliary Vehicles / Management Vehicles. A fee will be charged equal the actual cost of hiring and constructing facilities. Please note that NO power is provided to any sites.

To request an area, please complete and return the form from our official web, or please contact the Competitor Support Manager by Tuesday, 8 October 2013 (First Come First Serve).

Confirmation of your request will be official issued by the Organizers on Wednesday, 9 October 2013, 18:00 hrs.

### 5.3. Facilities

The following facilities will be at the service park :

- Food & Beverages
- Toilets
- Results Centre
- Sub Media Centre
- Sub Rally HQ & Sub Official Notice Board
- Stewards Tent

### 5.4. Type of Surface

The surface of the service park is hard gravel.



## RALLY GUIDE 1

### 6. RECONNAISSANCE

- 6.1. Summary of present regulations and specific instructions valid for the event**  
Reconnaissance may only be carried out using series production cars complying with Article 25.1 of the 2013 FIA Regional Rally Sporting Regulations. Tires used in reconnaissance must be designed primarily for use on tarmac roads. All competitors must use either the tires approved by the FIA, or may use an equivalent road tire provided written approval is obtained from the organizers prior to the start of reconnaissance. For all competitors reconnaissance will be carried out fully in accordance with the 2013 FIA Regional Rally Sporting Regulations with a maximum of **2 passes** over each stage in accordance with the Reconnaissance schedule give in Article 25.4 above.

A speed limit of 80km/h will be in force during reconnaissance of special stages. For reconnaissance purposes, any stage used more than once during the Rally counted as a single stage.

Reconnaissance may be carried out in any road-registered vehicle. Advertising, underbody protection, safety equipment and internal navigational aids are permitted.

The tires to be used are to have a maximum groove width and depth of 8mm and no other opening in the tread may be greater than 12mm (worn rally tires are not to be used). Tires marked M+S having a non-aggressive tread pattern may be used, but only after a written application by a competitor has been approved by the Clerk of the Course or his representative. Tires on the FIA list are also allowed.

- 6.2. Registration for Reconnaissance**  
Before starting reconnaissance all crews must supply the Organizers with full details of the Reconnaissance Car. Each crew will be issued with one sticker vehicle identification number which must be displayed on the top left of the front windscreen and one identification cards displayed on the left rear side window during reconnaissance.
- 6.3. Reconnaissance Schedule**  
The Reconnaissance Schedule is includedis included in **Appendix A**.

### 7. SHAKEDOWN / TESTING

- 7.1. Shakedown**  
Shakedown eliminated
- 7.2. Testing**  
Participants will be provided for the stage that will do the testing. Details of testing can contact the Committee
- 7.3. Testing Schedule**  
Monday untill Wednesday , 7 – 9 October 2013, 09:00 – 16:00 hrs

### 8. MEDIA

- 8.1. Accreditation Procedure/Criteria and Deadline**  
Media personnel intending to cover the INDONESIA RALLY 2013 are required to complete the Media Accreditation Form, attach all required documentation and forward to the Secretariat.  
Applications may be first sent by fax, however the original must then be sent by mail.



## RALLY GUIDE 1

For all enquiries about media accreditation prior to the Rally please contact either the secretariat or visit our official web site.

### 8.2. Contact Details

The Media Room and Accreditation Office are located in the Rally Headquarters, Contact Details to Media Relation Officers :

- **Mr. Armansyah Taher**  
 Mobile Phone : **+62 821 6151 1611**  
 e-mail : [armanth70@gmail.com](mailto:armanth70@gmail.com)

### 8.3. Accreditation Form

The accreditation request form will be made available on be the INDONESIA RALLY 2013 website : [www.imi-sumut.or.id](http://www.imi-sumut.or.id)

### 8.4. Media Centre Hours of Operation :

Wednesday, 9 October	09:00 - 20:00 hrs
Thursday, 10 October	09:00 - 20:00 hrs
Friday, 11 October	07:00 - 21:00 hrs
Saturday, 12 October	07:00 - 20:00 hrs
Sunday, 13 October	07:00 - 21:00 hrs
Monday, 14 October	09:00 - 12:00 hrs

## 9. TWO-WAY RADIO COMMUNICATION AND MOBILE PHONES

### 9.1. Application Procedure

A License is required for the use of radio communications in North Sumatra, Indonesia Competitors wishing to use two-way radios during INDONESIA RALLY 2013 must be submitted application letter to the Organizers.

The Organizers will advise the appropriate charge once the Department Telecommunication approval received.

Please be advised that all equipment acceptable for use in North Sumatra must fall within the following frequency bands :

From	To
70 MHz	87.5 MHz
149.25 MHz	156 MHz
157.5 MHz	174 MHz
403 MHz	420 MHz
450 MHz	520 MHz

A license can be obtained for a 12 month period or just for the period of the Rally.

### 9.2. Contact details to person / authority in charge

Please contact the Rally Office if you require assistance with your application.

### 9.3. Mobile Phone

Indonesia support two types of mobile service – GSM and CDMA.

Mobile Phone coverage will not be available on some site of the Special Stage, and may be intermittent on others. Telkomsel provides (GSM) the best overall coverage for the Rally Route.





## RALLY GUIDE 1

People bringing Mobile Phones from outside Indonesia are advised to check with their local provider to establish whether their company has a reciprocal agreement with Telkomsel. If this is not the case it is advisable to buy a Prepaid SIM Card in Indonesia.

### 10. FUEL

#### 10.1. Fuel / Refuelling Regulations

The Organizers have constructed a fuel storage compound at the Service Park adjacent to the refuel area. Crews are required to store all their fuel in this storage compounds before, during and after the rally.

Fuel can only be removed from the storage compound immediately prior to the arrival of the competing car at the refuel area. On completion of refueling, containers must be returned to the fuel storage compound.

The use of Official FIA fuel is permitted but will not be made available by the Organizers  
Refuel Zone: Fuel filling is only allowed to do at Refueling Area located in Rambong Sialang Service Park and 7 (seven) times Refuel as on the Itinerary.

### 11. HOSPITALITY ARRANGEMENTS

#### 11.1. Contact Details for person in charge for hospitality arrangements

There is a range of Corporate Hospitality facilities available at the INDONESIA RALLY 2013.

For details and prices please call :

Mrs. TINA, Competitor Support Manager

Mobile: +62 811 606 436

e-mail: [info\\_sekretariat@imi-sumut.or.id](mailto:info_sekretariat@imi-sumut.or.id)

or visit our official web site for more information :

[www.imi-sumut.or.id](http://www.imi-sumut.or.id)

### 12. HOTEL / ACCOMODATION RESERVATION

#### 12.1 Contact Details for Reservations

The Rally Office would be pleased to assist competitors in coordinating their accommodation arrangements. To make a booking please complete the enclosed accommodation form and return it to the Rally Office at either the fax number or email listed below. Rally Office staff will make the reservation on your behalf and provide you with confirmation of your arrangements.

INDONESIA RALLY 2013

Fax: +6261 452 8821

e-mail : [info\\_sekretariat@imi-sumut.or.id](mailto:info_sekretariat@imi-sumut.or.id)

#### 12.2 List of Hotels

The INDONESIA RALLY 2013 has secured rooms at a range of hotels and apartments in the city. Below are just a few properties available, for other options please email your requirements to [:info\\_sekretariat@imi-sumut.or.id](mailto:info_sekretariat@imi-sumut.or.id)



## RALLY GUIDE 1

### 12.3 HOTELS

- **TIARA HOTEL \*\*\*\***  
Cut Meutiah St, no. 1, Medan  
Tel.:+6261 457 4000, 451 9414
  
- **DANAU TOBA INTERNATIONAL HOTEL \*\*\*\*\***  
Imam Bonjol St, no. 17, Medan  
Tel.:+6261 415 7000  
Fax:+6261 453 0553
  
- **ASEAN BEST WESTERN HOTEL INT'L \*\*\*\***  
H. Adam Malik St, no. 5, Medan  
Tel.:+6261 456 3888, 457 5888  
Fax:+6261 456 1968, 456 1978, 452 1125
  
- **DHARMA DELI \*\*\***  
Balai Kota St, no. 2, Medan  
Tel.:+6261 415 7744, 414 7744  
Fax:+6261 414 4477
  
- **GARUDA PLAZA HOTEL INT'L \*\*\***  
Sisingamangaraja St, no. 18, Medan  
Tel.:+6261 736 7733, 736 8553  
Fax:+6261 787 9147
  
- **GRAND ANGKASA INT'L HOTEL \*\*\*\*\***  
Sutomo St, no. 1, Medan  
Tel.:+6261 455 5888, 455 0222
  
- **JW MARRIOTT HOTEL\*\*\*\*\***  
Putri Hijau St. no. 10, Medan  
Tel.:+6261 455 3333
  
- **GRAND SWISS BEL-HOTTEL\*\*\*\*\***  
S.Parman St. no. 217, Medan  
Tel.:+6261 457 6999
  
- **ARYADUTA HOTEL\*\*\*\*\***  
Kapten Maulana Lubis St. no. 8, Medan  
Tel.:+6261 457 2999
  
- **SANTIKA DYANDRA HOTEL\*\*\*\***  
Kapten Maulana Lubis St. no. 7, Medan  
Tel.:+6261 451 1999
  
- **GRAND ASTON CITY HALL HOTEL \*\*\*\***  
Balai Kota .St. no. 1, Medan  
Tel.:+6261 455 7000
  
- **THEME PARK PANTAI CERMIN HOTEL**  
Dusun 1 Desa Pantai Cermin Kanan  
Kecamatan Pantai Cermin  
Kabupaten Sergai no. 7, Medan  
Tel.:+6261 797 0266
  
- **POLONIA HOTEL\*\*\*\***  
Sudirman.St. no. 14, Medan  
Tel.:+6261 453 5111

## 13. LIST OF USEFUL FACTS AND SERVICES

### 12.4 Fact About North Sumatra

The province of North Sumatra stretches across the island of Sumatra between the Indian Ocean and the Strait Malacca. It borders Aceh province on the northwest and Riau and West Sumatra provinces in the southeast. It has an area of 72,981 km<sup>2</sup>. The province contains a broad, low plain along the Strait of Malacca on which the provincial capital, Medan, is located.



## RALLY GUIDE 1

In the south and west, the land rises to the mountain range that runs the length of Sumatra; the mountains here are dominated by Lake Toba, formed from the caldera of an ancient volcano. Several large islands in the Indian Ocean off the west coast of Sumatra are currently part of North Sumatra, most notably Nias Island and the Batu Islands

### **Population**

North Sumatra recorded a population of 12,985,075 in the 2010 national census, with a sex ratio of 99.59 men per 100 women.

### **Language**

Indonesia

### **Bank & Credit Card**

Banks are open from Monday to Friday, 08:30 – 15:00 hrs.

Automatic Teller Machines operate 24 hours a day. Major credit cards are welcome in most places.

### **Currency**

The Indonesia Rupiah (IDR) is a decimal currency with units in Rupiah.

The smallest coin is 50 cent.

The notes are

Rp.1000,-Rp.2000,- Rp. 5000,- Rp.10.000,-Rp.20.000,- Rp.50.000,-and Rp.100.000,-

The coins are

Rp. 50,- Rp. 100,- Rp. 200,- Rp. 500,- Rp. 1000,-

Currency can also be changed at any Bank or Financial Institution within Makassar – Indonesian (see Banking Hours).

### **Goods & Services Tax (GST)**

Indonesia adopted a 10% Goods and Service tax which will replace wholesale sales tax.

The GST applies to most, but not all, goods and services. GST will be included in the price you pay and, in most instances, will be itemized on your receipt. The price quoted will be inclusive of any GST. The GST paid by overseas travelers on some goods can be claimed on leaving the country (see below).

### **Public Telephones**

International calls can be made from public telephones in Indonesia / Medan

Most public telephones in Indonesia /Medan now also use pre-paid phone cards, which are available from many retail outlets such as newsagents, food stores, shopping centre.

(Remember : if you are, call to overseas you need to dial + or 001 or 008 before country phone code and phone number).

### **Power Voltage**

The Indonesian domestic standard is AC 220 - 240 volts.

### **Banking Hours**

Banks are open from Monday to Friday, 08:30 – 15:00 hrs.

Automatic Teller Machines (ATM) operate 24 hours a day. Major credit cards are welcome in most places.

### **Airport**

The modern Kuala Namu International Airport is opened in July 25, 2013 and located almost 40 kilometers from Medan. The airport replaces the old Polonia International Airport.



## RALLY GUIDE 1

### Seaports

North Sumatra has an International Seaport at Belawan, near Medan and is now preparing to have a new seaport at Kuala Tanjung.

### Visa

The Indonesian Government required Passport validation must be at least 3 month prior to expiration date.

### Driving

Driving on the left hand side of the road.

Reciprocal driving rights exist between Indonesia and most other countries.

### Weather

Climate	: Indonesia has largely equatorial tropical climate tempered by trade winds. There are only two seasons, the dry Season between April and October, and the rainy season from November to March.
Temperature	: Maximum 33 degree Celsius, minimum 25 degree Celsius.
Rainfall	: 37 - 49 mm/month, 55 mm/month (mountain area)
Weather	: Generally very cloudy
Relative Humidity	: Range 43 % to 75 %
Wind	: East to North Eastern lies at ranging 5 – 12 km/h
Sunrise	: Average for the months of August & October 06:00 hrs
Sunset	: Average for the months of August & October 18:00 hrs

*Weather forecast on Badan Meteorologi & Geofisika-Meteorologi website:*

[http://www.bmkg.go.id/bmkg\\_pusat/meteorologi/Prakiraan\\_Cuaca\\_Propinsi.bmkg?prop=02](http://www.bmkg.go.id/bmkg_pusat/meteorologi/Prakiraan_Cuaca_Propinsi.bmkg?prop=02)

### World Times

West Indonesian Standard Time is GMT plus 7 hours.

This is the standard time that applies in Medan (North Sumatra), Palembang (South Sumatra), Bandung (West Java), Surabaya (East Java),

At **12:00** noon in **Medan** is:

<b>Bangkok</b>	<b>12:00 hrs</b>
<b>Jakarta</b>	<b>12:00 hrs</b>
<b>Kuala Lumpur</b>	<b>13:00 hrs</b>

### 15.1 AIRLINES

- **GARUDA INDONESIA AIRLINES**  
Monginsidi St, no. 34 A, Medan Tel.:+6261 455 6111
- **MERPATI NUSANTARA AIRLINES**  
Samanhudi st. no. 1A Medan Tel.:+6261 457 5353
- **MANDALA AIRLINES**  
Brigjend Katamso St, no. 37 E, Medan Tel.:+6261 457 9100
- **MALAYSIA AIRLINES**  
Imam Bonjol St, no. 17  
(Hotel Danau Toba Int'l), Tel.:+6261 451 9333, 451 4300
- **STAR AIR**  
Iskandar Muda St, no. 280, Medan Tel.:+6261 451 8222
- **JATAYU AIRLINES**  
Brigjen Katamso St, no. 62, Medan Tel.:+6261 452 8988
- **LION AIRLINES**  
Citra Garden Medan Tel.:+6261 822 0011



## RALLY GUIDE 1

- **SRIWIJAYA AIRLINES**  
Brigjend Katamso st. no. 29 A, Medan Tel.:+6261 451 9074
- **CITYLINK AIRLINES**  
Sisingamangaraja st. no. 55 E, Medan Tel.:+6261 735 9316

### 15.2 BANK

- **PERMATA BANK**  
KH. Zainul Arifin ST, no. 49 – 51, Medan Tel.:+6261 452 6000
- **B N I BANK**  
Pemuda St, no. 12, Medan Tel.:+6261 456 1806
- **CIMB BANK, PT.**  
Bukit Barisan St, no. 5, Medan Tel.:+6261 453 0515
- **SUMUT BANK**  
Imam Bonjol St, no. 18, Medan Tel.:+6261 415 5100
- **B C A BANK, PT.**  
Diponegoro St, no. 18, Medan Tel.:+6261 455 3800  
Bukit Barisan St, no. 3 Medan Tel.:+6261 451 5800
- **B I I BANK**  
Diponegoro St, no. 18, Medan Tel.:+6261 456 8811
- **DANAMON BANK**  
Pemuda St, no. 5 AB, Medan Tel.:+6261 415 4611  
Diponegoro St. no. 35, Medan Tel.:+6261 457 9999
- **MANDIRI BANK**  
Balai Kota St, no. 8-10, Medan Tel.: +6261 451 7371
- **HSBC BANK**  
Diponegoro St, no. 11, Medan Tel.:+6261 453 8080
- **BRI BANK**  
Putri Hijau St, no. 2, Medan Tel.:+6261 457 6555
- **MESTIKA DHARMA BANK, PT.**  
H. Zainul Arifin St, no. 118, Medan Tel.:+6261 452 5800
- **CITY BANK**  
Imam Bonjol St, no. 23, Medan Tel.:+6261 452 5982
- **STANDARD CHARTERED BANK**  
Imam Bonjol St, no. 17, Medan Tel.:+6261 451 2000
- **BUMI PUTRA INDONESIA BANK**  
Iskandar Muda St, no. 138, Medan Tel.:+6261 452 2110
- **KESAWAN BANK**  
Palang Merah St, no. 110, Meda Tel.:+6261 451 8300
- **PANIN BANK, PT Tbk.**  
Pulau Pinang St, no. 6, Medan Tel.:+6261 453 8460
- **ABN – AMRO BANK**  
Imam Bonjol St, no. 26 A, Medan Tel.:+6261 415 4488

### 15.3 RESTAURAN

- **ACC Restaurant**  
Palang Merah St, no. 2, Medan Tel.:+6261 451 0870  
Putri Hijau St, no. 8 JK, Medan Tel.:+6261 455 1349  
St. Iskandar Muda St, no. 115/148 AB, Medan Tel.:+6261 415 3440  
Jend. Gatot Subroto St, no. 135/137, Medan Tel.:+6261 847 6752  
Sumatera St, no. 108 – 109, Medan Tel.:+6261 414 6579
- **GARUDA GROUP Restaurant**  
H. Adam Malik St, no. 14 – 40, Medan Tel.:+6261 452 0891  
Gajah Mada St, no. 8, Medan Tel.:+6261 457 7900  
Kapt. Pattimura St, no. 328, Medan Tel.:+6261 455 5800  
Nibung Raya St, no. 163 – 165, Medan Tel.:+6261 452 5160  
Palang Merah St, no. 26, Medan Tel.:+6261 453 7813



## RALLY GUIDE 1

- **Rumah Makan SEDERHANA**  
Pattimura St, no. 137, Medan Tel.:+6261 800 1588
- **MIRAMAR Restaurant**  
Pemuda St, no. 11 AB, Medan Tel.:+6261 455 5491
- **TIP – TOP**  
Jend Ahmad Yani St, no. 92, Medan Tel.:+6261 453 2042
- **MEDAN CLUB**  
Kartini St, Medan Tel.:+6261 451 0133
- **KENTUCKY FRIED CHIKEN**  
**KFC**  
 Jalan Adam Malik Medan, Indonesia  
**KFC**  
 Sun Plaza, Jl. Kh. Zainul Arifin No. 7, Medan, Tel.:+6261 4501036  
**KFC**  
 Jalan Gajah Mada, Medan  
**KFC - Simpang Mataram**  
 JL. Gajah Mada 14 Mataram Medan, Indonesia Tel.:+6261 4153589  
**KFC Simpang Sutomo (Nomensen) Medan**  
 Simpang Sutomo (Nomensen) Medan,  
 Jl. Perintis Kemerdekaan, Medan, Tel.:+6261 4554650  
**KFC Raja Medan**  
 Jl Sisingamangaraja No 41 Medan, Tel.:+6261 878 8881-0867 . .  
**KFC Taman Lily Suhery Medan**  
 Jl. Listrik /, Jl. Palang Merah No. 1, Medan, Tel.:+6261 4527500  
**KFC Cemara Asri Medan**  
 Jl. Komp. Cemara Asri, Medan, Tel.:+6261 685 9864  
**KFC Asia Mega Mas Medan**  
 Jl. Sukaramai II, Kel. Sukaramai II, Medan, Tel.:+6261 661 8403  
**KFC Adam Malik Medan**  
 Jl. Adam Malik No. 5 / 7, Medan, Tel.:+6261 452 0122  
**KFC**  
 Jl. Mongonsidi Simpang Walikota No.14, Medan, Tel.:+6261 451 2727
- **TEXAS FRIED CHICKEN**  
Thamrin Plaza St, M.H. Thamrin no. 75R, Medan,  
Plaza Medan Fair floor 1, Medan
- **PIZZA HUT**  
 Adam Malik St, no. 15, Medan Tel.:+6261 456 6139  
 Let. Jend Suprpto St, no. 13, Medan Tel.:+6261 451 2473  
 Medan Mall St, M.T. Haryono no. 13, Medan Tel.:+6261 4527 590  
 Sun Plaza St, H. Zainul Arifin, Medan Tel.:+6261 450 1041  
 Merdeka Walk No. 1, JL. Balai Kota, No. 1, Medan Tel.:+6261 452 7800
- **Mc. Donald's**  
Balai kota st, no 99 Medan Tel.:+6261 4570 232
- **JUMBO Restaurant**  
Putri Putri Hijau St, no. 8 BCD, Medan
- **NEW NELAYAN RESTAURANT**  
Putri Merak Jingga St. no. 8 AB, Medan Tel.: +6261 452 5532  
Merdeka Walk Medan



## RALLY GUIDE 1

- **WARINGIN SEAFOOD**  
Waringin St., Medan

### 15.4 TAXI

- **Blue Bird Taxi**  
JL. Kapten Muslim No. 92, Sei Sikambing, Medan, Tel.: +6261 846 1234

### 15.5 RENT CAR

- **TRAC ASTRA RENT CAR**  
JL. Sutomo, No. 1, Medan, Tel.:+6261 7780 702
- **TRAC ASTRA RENT CAR**  
Gatot Subroto St, no. 151, Medan Tel.: +6261 847 0909
- **KIA RENT CAR MEDAN**  
Jl.Tuar no.7, Medan, Tel.: +6261 7777 7977,+6281 2637 77779
- **MEDAN 88 RENTCAR**  
Jl.Sei Padang Ujung, Medan, Tel: +6261 7737 7617,+62813 7066 6838
- **ARMADA CAR RENTAL**  
Jl. Bunga Sedap Malam III No. 4, Medan Tel.:+6261 7512 4951,+6282 3630 44111

### 15.6 TYRE SERVICE

- **Express Tyre Service Center**  
JL MH Thamrin 22 D-E, Pasar Baru, Medan, Tel.:+6261 4531 910
- **Stasiun Service**  
JL. Stasiun Kereta Api, No. 2-4, Medan, Tel.:+6261 4518 305
- **Cakrawala Ban**  
Jl.Brigjend Katamsso No.785, Medan, Tel.:+6261 7868413
- **Banindo Perkasa. UD**  
Jl.H Adam Malik, 100/90, Medan, Tel.:+6261 6618 017
- **Bintang Ban**  
JL. Jenderal Gatot Subroto, Km. 5, No. 150, Medan, Tel.:+6261 8468 805
- **Express Ban**  
JL Perintis Kemerdekaan 2-A, Medan, Tel.:+6261 4522 171
- **Uni Ban**  
JL. Profesor HM Yamin SH, No. 72A, Medan, Tel.:+6261 4150 332
- **Nasional Ban**  
JL. Stasiun Kereta Api, No. 1C-D, Medan, Tel.:+6261 4525390
- **Guna Ban**  
JL. Stasiun Kereta Api 3, Medan, Tel.:+6261 4522 517
- **Eka Perdana Ban UD**  
JL. Stasiun Kereta Api 16, Medan, Tel.:+6261 4535 684
- **Kencana Sakti Ban**  
JL. Profesor HM Yamin SH, 42-DE, Medan, Tel.:+6261 4528 905
- **Aneka Ban. UD**  
JL Prof HM Yamin SH 6-A, Medan, Tel.:+6261 4528 509
- **Laris Ban**  
JL. Prof HM Yamin SH 70 F, Medan, 20234, Tel.:+6261 4555 705
- **Medan Ban**  
JL. MH Thamrin, No. 75 K, Medan, Tel.:+6261 4560 153
- **Utama Ban**  
Jalan Gajah Mada, Medan, Tel.:+6261 4142 063
- **Ban Persaudaraan Toko**  
JL. Ir H Juanda Baru 27, Medan, Tel.:+6261 7355 975
- **Indo Ban**  
JL. Letnan Dua Sujono, 53-54, Medan, Tel.:+6261 7348 758
- **Continent Ban**  
JL. Setia Budi, No. 244/244A, Medan, Tel.:+6261 8219 178



## RALLY GUIDE 1

- **Ratu Ban**  
JL. Sisingamangaraja, No. 39, Medan, Tel.:+6261 7341 351
- **Bansindo Jaya**  
JL. Titi Pahlawan, No. 16-20, Marelan, Medan, Tel.:+6261 4533 313
- **Citra Ban**  
JL. Letjen Jamin Ginting 53, Medan, 20155, Tel.:+6261 8212 705
- **Pangeran Ban**  
JL. Letnan Jenderal S Parman, No. 91, Medan, Tel.:+6261 528 196

### 15.7 PHARMACIES

- **APOTEK ASKES**  
Prof. H.M. Yamin SH St, no. 176 C, Medan Tel.:+6261732 0344
- **APOTEK KIMIA FARMA**  
Palang Merah St, no. 32, Medan Tel.:+6261 453 8938  
Gatot Subroto St. no. 72 C Medan Tel.:+6261 414 7927  
Sisingmangaraja St. No. 374 - 374 A, Medan, Indonesia Tel.:+6261 786 0468
- **OPOTEK K24**  
Prof. HM. Yamin, SH St, no. 216 C, Medan Tel+6261 455 5542
- **APOTEK MATAHARI**  
Jend. Gatot Subroto St, no. 73, Medan Tel.:+6261 452 9373
- **APOTEK MEDAN BARU**  
Iskandar Muda St, no. 148 D, Medan Tel.:+6261 452 7207
- **APOTEK BENTENG**  
KH. Zainul Arifin St, no. 149, Medan Tel.:+6261 456 5483
- **APOTEK PATEN**  
S.M. Raja St, no. 41, Medan Tel.:+6261 734 7651
- **APOTEK PELITA**  
Letjend. Haryono MT St, no. 34, Medan Tel.:+6261 457 4254
- **APOTEK RENIKA**  
Setia Budi St, no. 152, Medan Tel.:+6261 821 2521
- **APOTEK VITA BINTANG**  
K.H. Zainul Arifin St, no. 85, Medan Tel.:+6261 453 7328

### 15.8 CONSULATES

- **GERMANY**  
Abdullah Lubis St no. 47 A, Medan, Tel.:+62 61 415 2424
- **INDIA**  
Mgr. Sugiopranoto St, Medan Tel.:+62 61 455 6452
- **JAPAN**  
Wisma BII 5<sup>th</sup> floor, 18 Pangeran Diponegoro St, Medan Tel.:+62 61 4575 193  
Fax:+ 62 61 4574 566
- **MALAYASIA**  
43 Pangeran Diponegoro St, Medan Tel.:+ 6261 453 1342





## RALLY GUIDE 1

### 14. SCRUTINEERING / SEALING AND MARKING

#### 16.1. Scrutineering, Sealing and Marking

Administrative Check must be complete prior to Scrutineering and Competition Numbers, Rally Plate and Advertising decals shall be affixed on the car before entering the Scrutineering venue.

#### 16.2. Location

Place : Benteng Square. Medan

Time : Friday, 11 October, 08:00 – 12:00 hrs.

#### 16.3. Schedule

Specific time will be notified by Bulletin to be published at 18:00 hrs

Thursday, 10 October 2013 on the Official Notice Board – Rally HQ.

#### 16.4. Preparations to be made before car is brought to scrutineering

The drivers' equipment (helmet and apparel) will be checked at scrutineering. Competitors in the INDONESIA RALLY 2013 are reminded that apparel must comply with FIA Standard FIA8856-2000.

In addition, all crews must report to scrutineering with Rally Plates, numbers and optional advertising (if accepted) affixed to the car.

#### 16.5. Road Book to Scrutineering from Rally HQ

A route chart from Rally HQ to the Scrutineering venue at the Benteng Square is included in **Appendix D**.

#### 16.6. Final scrutineering

The Rally will conclude at the end of the Rally Parc Fermé In Control at the Rambong Sialang Parc Ferme ( TC.9C )

Cars which appointed to be checks, will be taken under the Organizers supervision to Post - Event scrutiny.

**Place** : Rambong Sialang Parc Ferme, Lonsum Estate

**Time** : Sunday, 13 October, 14:15 hrs

After Final Scrutineering at the Parc Fermé, competitors shall follow the Officials to convoy to the Finish ramp at Benteng Square, Medan

In case that the car is not driveable, this shall be reported to the Clerk of the Course who will arrange transport by Recovery Vehicle.

### 15. START PROCEDURE

#### 17.1. Ceremonial Start

Place : Benteng Square, Medan

Time : Friday 11 October 2013, First car schedule 16:30hrs

All competitors must participate in the Ceremonial Start which will held at the Benteng Square, Medan. Any competitor fails to participate will be referred to the Stewards for sanction.



## RALLY GUIDE 1

The Start order at the Starting Podium will be according to the Ceremonial Starting List, which will be published on Friday, 11 October, 14:00 hrs.

The Start order will be as follows:

Starting order begins from the highest car number to the lowest car number for all competitors, Tri Nations Rally Championships and National Rally Championship

### 17.2. Pre- Start Park

A Pre-Start Park, open from 15:00 hrs.

Cars must be placed in Waiting Area Start Ceremony / Pre-Start Park

Benteng Square, Medan, and may be done by another crew / not the Driver or Co-Driver.

Scheduled no later than 16:00 hrs for all participants Vehicles.

Parked the Rally vehicle as dictated by the Committee. It is not necessary that a member of the crew be the person who places the vehicle in the Pre-Start Park.

**Note:** No Time Penalty imposed for the time delay in reporting the Start Ceremony Pre-Start Park. Participants who reported a vehicle outside the time be fined up to Rp. 50.000, - / min, with a maximum of Rp. 750.000, -

∴

A route chart from Rally HQ to the Ceremonial Start entry and from the Ceremonial Start back to Rally HQ is included in **Appendix D**.

A layout of the Ceremonial Start is included in **Appendix C**.

### 17.3. Start Leg 1

Place : Rambong Sialang Parc Ferme

Time : Saturday 12 October 2013, First car schedule 09:00 hrs

#### 17.3.1. Procedure and Instructions

The Organisers have located prior to the Start of the Leg 1, a starting area which is considered Parc Ferme. It is each competitor's responsibility to ensure that the vehicle is placed in this starting area at Rambong Sialang Parc Ferme on Saturday, 12 October 2013, no later than 08:00 hrs

Any delay in reporting to the Starting Area Parc Ferme will be penalized at the rate of Rp. 50.000,- = US\$. 5 per minute, with a maximum of Rp. 750.000, -

The Start order at the Start Leg 1 will be according to the Start Leg 1 List, which will be published on Friday, 11 October, 14:00 hrs.

A route chart from Rally HQ to the PG. Takalar Parc Ferme entry and from the PG. Takalar Parc Ferme back to Rally HQ is included in **Appendix D**.

#### 17.3.2. Layout of Parc Ferme

A diagram of the PG. Takalar Parc Ferme layout is included in **Appendix C**.

## 16. FINISH PROCEDURE

### 18.1. Location and time

Place : Benteng Square, Medan.

Time : Sunday, 13 October 2013, 19:30 hrs



## RALLY GUIDE 1

### 18.2. Programme, Procedure and Instructions

All competitors will Convoy follow the road book from Rambong Sialang Parc Ferme, to the Finish Park, Benteng Square, Medan

A Ceremonial Rally Finish and Prize Giving will be held at 19:30 hrs on Sunday 13 October 2013 on the Finish Ramp at the Benteng Square, Medan.

The Ceremonial Finish sequence as follow :

#### THE GENERAL CLASSIFICATION WINNERS CEREMONIAL FINISH

- All the Indonesia Rally 2013 competitors cross the Finish Ramp, begins from the lowest position to the highest position for receive the Finisher Awards and Trophy, 20 seconds on the ramp for photos.
- The third placed Indonesia Rally 2013 competitors will then drive onto the finish ramp and the crew exits the car shake hands with the VIP's, for a photo and interview (20 seconds). After the interview they exit the finish ramp and park the car to the left of the finish ramp. Driver and Co-Driver go to one side for trophy presentation as directed by the official.
- The second Indonesia Rally 2013 competitor will then drive onto the finish ramp and the crew exits the car shake hands with the VIP's, for a photo and interview (20 seconds). After the interview they exit the finish ramp and park the car to the right of the finish ramp. Driver and Co-Driver go to one side for trophy presentation as directed by the official.
- The winning Indonesia Rally 2013 car then drives onto the finish ramp, with the nose of the car dropped onto finish ramp. The winning crew will then exit the car shake hands with the VIP's, for a photo and interview (maximum 30 seconds).
- All crews will then climb onto the podium box for the trophy presentation, winning driver's National Anthem played as National flags of the 1st, 2nd, 3rd placed drivers raised and continue with the traditional champagne spraying by all Drivers and co-Drivers

#### THE TRI NATIONS RALLY CHAMPIONSHIP 2013's CEREMONIAL FINISH

- After the Indonesia Rally 2013's finish procedure, the 1st, 2nd, 3rd General Classification winners Tri Nation's Registered competitors shall cross the finish ramp begins from the lowest position to the highest position for receive the Finisher Awards and Trophy, 20 seconds on the ramp for photos.
- The same procedure for the 1st, 2nd, 3rd General Classification winners, if all 3 first Tri Nation's Rally Championship same with first 3 outright General Classification the Ceremony shall be done at once with the Indonesia Rally 2013's Ceremonial Finish
- The 1st, 2nd, 3rd winners do the same procedure as the above Indonesia Rally 2013's ceremony, the crew exits the car shake hands with the VIP's, interview, trophy presentation, National Anthem played as National flag raised and the traditional champagne spray.

### 18.3. Lay out of Finish area

A diagram of the layout of the Ceremonial Finish is included in **Appendix C**.



## RALLY GUIDE 1

### 17. PR ACTIVITIES

- **SCRUTINEERING AND COMPONENT SEALING & MARKING**  
Friday, 11 October, 08:00 - 14:00 hrs  
Benteng Square, Medan  
A route chart from Rally HQ to the Benteng Square is included in **Appendix D.**
- **PRE-EVENT PRESS CONFERENCE**  
Friday, 11 October, 15:00 hrs,  
Deli Room Medan Club, Medan  
A route chart from Rally HQ to the Medan Clubis included in **Appendix D.**
- **WELCOME DINNER**  
Friday, 11 October, 19:30 hrs  
The State Government of Governor Residence  
A route chart from Rally HQ to the Governor Residenceis included in **Appendix D.**
- **CEREMONIAL START**  
Friday, 11 October 2013, 16:30 hrs  
Benteng Square, Medan
- **CEREMONIAL FINISH**  
Sunday 13 October 2013, 19:30 hrs  
Benteng Square, Medan
- **POST-EVENT PRESS CONFERENCE**  
Sunday 13 October 2013. 20:30 hrs  
Benteng Square, Medan



## RALLY GUIDE 1

### 18. MEDICAL AND SAFETY SERVICES

Emergency number, list of hospitals, telephone numbers to police, pharmacies etc

#### EMERGENCY NUMBER

POLICE	
Medan City Police	+6261 452 0971
Sergei Resort Police	+6261 442074, +6261 442088
Deli Serdang Resort Police	+6261 882 1071
Polsek Rampah	+6261 0811 625 820

#### EMERGENCY SERVICES AND HOSPITAL

AMBULANCE		118
Medical Official	Dr.M.Syafrin Syahlevi	+6261 813 6104 2104
<b>Columbia Asia Medan</b> <i>Jl. Listrik No. 2A</i>		+6261 456 6368
<b>RS.Islam Malahayati</b> <i>Jl.Diponegoro No.2-4</i>		+6261 451 8766
<b>RS.Santa Elisabeth</b> <i>Jl.H.Misbah No.7</i>		+6261 414 4737
<b>RSU. Pirngadi Medan</b> <i>Jl. Prof. H.M. Yamin, SH</i>		+6261 453 6022, 453 5981
<b>RSU. Deli Serdang Lubuk Pakam</b> <i>Jl. MH. Thamrin No. 99 Lubuk Pakam</i>		+6261 795 4477
<b>RSU. Grand Medistra</b> <i>Jl. Medan Lubuk Pakam No. 14/64</i>		+6261 795 5144
<b>RSU. Sawit Indah</b> <i>Jl. Pantai Cermin No. 10 Perbaungan</i>		+6261 799 1977



# RALLY GUIDE 1

## APPENDIX A : ITINERARY

### A1. ITINERARY

## ITINERARY

### CEREMONIAL START - 11 Oct.

TC	Location	SS dist.	Liaison dist.	Total dist.	Target Time	First Car due
	Medan, BENTENG Square - Pre Start Park IN (E)					(Latest Report Time for All Cars: 16:00 hrs)
0	<b>Medan, BENTENG Square - CEREMONIAL START</b>					<b>16:30</b>

### LEG 1 - 12 Oct.

TC	Location	SS dist.	Liaison dist.	Total dist.	Target Time	First Car due		
0A	Rambong Sialang Parc Ferme <b>OUT - Start LEG 1</b>					9:00	SECTION 1	
0B	Service <b>IN</b>		0,10	0,10	0:02	9:02		
<b>SERVICE A (RAMBONG SIALANG)</b>			<b>(0,10)</b>	<b>(0,10)</b>	<b>0:15</b>			
0C	Service <b>OUT</b>					9:17		
<b>RZ1</b>	<b>Refuel R. Sialang</b> , 0.05 km after TC 0D, from previous RZ: Distance to next refuel	(43,97)	(6,49)	(50,46)				
1	Rambong Sialang A		2,72	2,72	0:08	9:25		
<b>SS1</b>	<b>Rambong Sialang A</b>	<b>22,63</b>				<b>9:28</b>		
2	Rambong Sialang B		2,83	25,46	0:50	10:18		
<b>SS2</b>	<b>Rambong Sialang B</b>	<b>21,34</b>				<b>10:21</b>		
2A	Pre Service Parc Ferme / Technical Zone <b>IN</b>		0,94	22,28	0:44	11:05		
2B	Pre Service Parc Ferme <b>OUT</b> / Flexi Service <b>IN</b>							
<b>FLEXI SERVICE B (RAMBONG SIALANG)</b>			<b>(43,97)</b>	<b>(6,49)</b>	<b>(50,46)</b>	<b>0:30</b>		
2C	Flexi Service <b>OUT</b> / Regroup <b>IN</b>					11:35	SECTION 2	
<b>Rambong Sialang Regroup - 1</b>								
2D	Regroup <b>OUT</b>					12:10		
<b>RZ2</b>	<b>Refuel R. Sialang</b> , 0.05 km after TC 2D, from previous RZ: Distance to next refuel	(43,97)	(6,49)	(50,46)				
3	Rambong Sialang C		1,32	1,32	0:06	12:16		
<b>SS3</b>	<b>Rambong Sialang C</b>	<b>18,87</b>				<b>12:19</b>		
4	Rambong Sialang A		2,84	21,71	0:43	13:02		
<b>SS4</b>	<b>Rambong Sialang A</b>	<b>22,63</b>				<b>13:05</b>		
4A	Pre Service Parc Ferme / Technical Zone <b>IN</b>		2,94	25,57	0:50	13:55		
4B	Pre Service Parc Ferme <b>OUT</b> / Flexi Service <b>IN</b>							
<b>FLEXI SERVICE C (RAMBONG SIALANG)</b>			<b>(41,50)</b>	<b>(7,10)</b>	<b>(48,60)</b>	<b>0:30</b>		
4C	Flexi Service <b>OUT</b> / Regroup <b>IN</b>					14:25	SECTION 3	
<b>Rambong Sialang Regroup - 2</b>								
4D	Regroup <b>OUT</b>					15:00		
<b>RZ3</b>	<b>Refuel R. Sialang</b> , 0.05 km after TC 4D, from previous RZ: Distance to next refuel	(41,50)	(7,10)	(48,60)				
5	Rambong Sialang B		2,00	2,00	0:06	15:06		
<b>SS5</b>	<b>Rambong Sialang B</b>	<b>21,34</b>				<b>15:09</b>		
5A	Pre Service Parc Ferme / Technical Zone <b>IN (E)</b>		0,94	22,28	0:44	15:53		
5B	Pre Service Parc Ferme <b>OUT</b> / Flexi Service <b>IN (E)</b>							
<b>FLEXI SERVICE D (Rambong Sialang)</b>			<b>(21,34)</b>	<b>(2,94)</b>	<b>(24,28)</b>	<b>0:45</b>		
5C	Flexi Service <b>OUT (E)</b>					16:38		
<b>RZ4</b>	<b>Refuel R. Sialang</b> , 0.05 km after TC 5C, from previous RZ: Distance to next refuel	(21,34)	(2,94)	(24,28)				
5D	<b>Rambong Sialang Overnight Parc Ferme IN (E)</b>		0,10	0,10	0:03	16:41		
<b>LEG 1 TOTALS:</b>		<b>106,81</b>	<b>16,73</b>	<b>123,54</b>				

- At the 30 minutes Flexi Services crews may wait for up to 35 minutes before entering the Service Park without incurring penalty

revised: 20 Sept.

- At the 45 minutes Flexi Services crews may wait for up to 50 minutes before entering the Service Park without incurring penalty

- (E) Denotes Early Arrival without incurring penalty



# RALLY GUIDE 1

## LEG 2 - 13 Oct.

TC	Location	SS dist.	Liaison dist.	Total dist.	Target Time	First Car due
5E	Rambong Sialang Parc Ferme <b>OUT</b> - Start LEG 2					9:00
5F	Service <b>IN</b>		0,10	0,10	0:02	9:02
<b>SERVICE E (RAMBONG SIALANG)</b>			<b>(0,10)</b>	<b>(0,10)</b>	<b>0:15</b>	
5G	Service <b>OUT</b>					9:17
<b>RZ5</b>	<b>Refuel R. Sialang</b> , 0,05 km after TC 5G, from previous RZ: Distance to next refuel	(40,12)	(4,64)	(44,76)		
6	Rambong Sialang C		1,32	1,32	0:06	9:23
<b>SS6</b>	<b>Rambong Sialang C</b>	<b>18,87</b>				<b>9:26</b>
7	Rambong Sialang B Reverse		1,06	19,93	0:39	10:05
<b>SS7</b>	<b>Rambong Sialang B - Reverse</b>	<b>21,25</b>				<b>10:08</b>
7A	Pre Service Parc Ferme / Technical Zone <b>IN</b>		2,26	23,51	0:46	10:54
7B	Pre Service Parc Ferme <b>OUT</b> / Flexi Service <b>IN</b>					
<b>FLEXI SERVICE F (RAMBONG SIALANG)</b>			<b>(40,12)</b>	<b>(4,64)</b>	<b>(44,76)</b>	<b>0:30</b>
7C	Flexi Service <b>OUT</b> / Regroup <b>IN</b>					11:24
<b>Rambong Sialang Regroup - 3</b>						
7D	Regroup <b>OUT</b>					11:59
<b>RZ6</b>	<b>Refuel R. Sialang</b> , 0,05 km after TC 7D, from previous RZ: Distance to next refuel	(40,12)	(4,64)	(44,76)		
		(41,45)	(7,34)	(48,79)		
8	Rambong Sialang C Reverse		0,62	0,62	0:05	12:04
<b>SS8</b>	<b>Rambong Sialang C - Reverse</b>	<b>18,83</b>				<b>12:07</b>
9	Rambong Sialang A-Reverse		3,79	22,62	0:44	12:51
<b>SS9</b>	<b>Rambong Sialang A - Reverse</b>	<b>22,62</b>				<b>12:54</b>
9A	Service <b>IN (E)</b>		2,93	25,55	0:50	13:44
<b>SERVICE G (RAMBONG SIALANG)</b>			<b>(41,45)</b>	<b>(7,34)</b>	<b>(48,79)</b>	<b>0:10</b>
9B	Service <b>OUT (E)</b>					13:54
<b>RZ7</b>	<b>Refuel R. Sialang</b> , 0,05 km after TC 9B, from previous RZ: Distance to next refuel	(41,45)	(7,34)	(48,79)		
			(59,07)	(59,07)		
9C	Regroup <b>IN (E)</b>					13:57
<b>Rambong Sialang Regroup - 4</b>						
9D	Regroup <b>OUT - Convoy (E)</b>					15:30
9E	Medan, BENTENG Square - <b>FINISH PARK IN (E)</b>		59,07	59,07	1:50	17:20
9F	<b>FINISH CEREMONY - MEDAN, BENTENG SQUARE</b>					<b>19:30</b>
<b>LEG 2 TOTALS:</b>		<b>81,57</b>	<b>71,15</b>	<b>152,72</b>		

SECTION 4

SECTION 5

- At the 30 minutes Flexi Services crews may wait for up to 35 minutes before entering the Service Park without incurring penalty
- At the 45 minutes Flexi Services crews may wait for up to 50 minutes before entering the Service Park without incurring penalty
- (E) Denotes Early Arrival without incurring penalty

revised: 20 Sept.

### TOTAL OF THE RALLY

	SS	Liaison	Total	%
LEG 1 - 5 Special Stages	106,81	16,73	123,54	86,46%
LEG 2 - 4 Special Stages	81,57	71,15	152,72	53,41%
<b>TOTAL - 9 Special Stages</b>	<b>188,38</b>	<b>87,88</b>	<b>276,26</b>	<b>68,19%</b>



## RALLY GUIDE 1

### A2. Special Stage Description

#### Leg 1 – Saturday, 12 October, 2013

Special Stage			Description	Remarks
SS 1 SS 4	22,63 km	Rambong Sialang A	The longest stage of this Rally, through palm plantations and natural bush, some road of hard packed sand, others of gravel on clay and grass. Mostly consists of the bend square, some twisting stage which likely to set a real challenge for crews.	<u>2012:</u> 18.14km
SS. 2 SS. 5	21.34 km	Rambong Sialang B	A smooth fast stage on a good hard clay over palm plantations., a great driver's stage which extremely slippery when wet. There are many crest and blind corners in the stage mostly consists of the bend square,	<u>2012:</u> 21.67km
SS. 3	24.34 km	Rambong Sialang C	A smooth fast stage on a good hard clay over palm plantations. Mostly consists of the bend square, some twisting stage, a great driver's stage which extremely slippery when wet. There are many crest and blind corners in the stage.	<u>2012:</u> 20.10km

#### Leg 2 – Sunday, 13 October, 2013

Special Stage			Description	Remarks
SS. 6	24.34 km	Rambong Sialang C	A smooth fast stage on a good hard clay over palmplantations. Very demanding and twisty, a great driver's stage which extremely slippery when wet. There are many crest and blind corners in the stage	<u>2012:</u> 20.10km
SS 7	21.25 km	Rambong Sialang B-Reverse	A smooth fast stage on a good hard clay over palm plantations., a great driver's stage which extremely slippery when wet. There are many crest and blind corners in the stage mostly consists of the bend square,..	<u>2012:</u> 22.24km
SS 8	18.83 km	Rambong Sialang C-Reverse	A smooth fast stage on a good hard clay over palm plantations. Mostly consists of the bend square, some twisting stage, a great driver's stage which extremely slippery when wet. There are many crest and blind corners in the stage.	<u>2012:</u> 19.91km
SS 9	22.62 km	Rambong Sialang A-Reverse	The longest stage of this Rally, through palm plantations and natural bush, some gravel roads on clay and grass. Most consist of a square corner, several stages of play that tends to set a real challenge for the crew	<u>2012:</u> 18.14km





## RALLY GUIDE 1

### A4. Reconnaissance Schedule

#### RECONNAISSANCE SCHEDULE

RECCE NO.	LOCATION	SS NO.	SPECIAL STAGES	DINSTANCE KM.	TIME	REMARKS
<b>Thursday, 10 Oktober 2013</b>						
All Competitors	Lonsum Estate	1 / 4	RAMBONG SIALANG A	22,63	08:00-14:00	Start from SS1/4 to SS2/5 to SS3/6 complete 2 X
		2 / 5	RAMBONG SIALANG B	21,34		
		3 / 6	RAMBONG SIALANG C	18,87		
	7	RAMBONG SIALANG B- REVERSE	21,25	14:30-17:30	Start from SS7 to SS8 to SS9	
	8	RAMBONG SIALANG C- REVERSE	18,83			
9	RAMBONG SIALANG A- REVERSE	22,62				
<b>Friday, 11 Oktober 2013</b>						
All Competitors	Lonsum Estate	7	RAMBONG SIALANG B- REVERSE	21,25	07:00-10:00	Dari SS7 ke SS8 ke SS9
		8	RAMBONG SIALANG C- REVERSE	18,83		
		9	RAMBONG SIALANG A- REVERSE	22,62		

**APPENDIX B : MAPS**

**B1. HOST CITY MAPS**

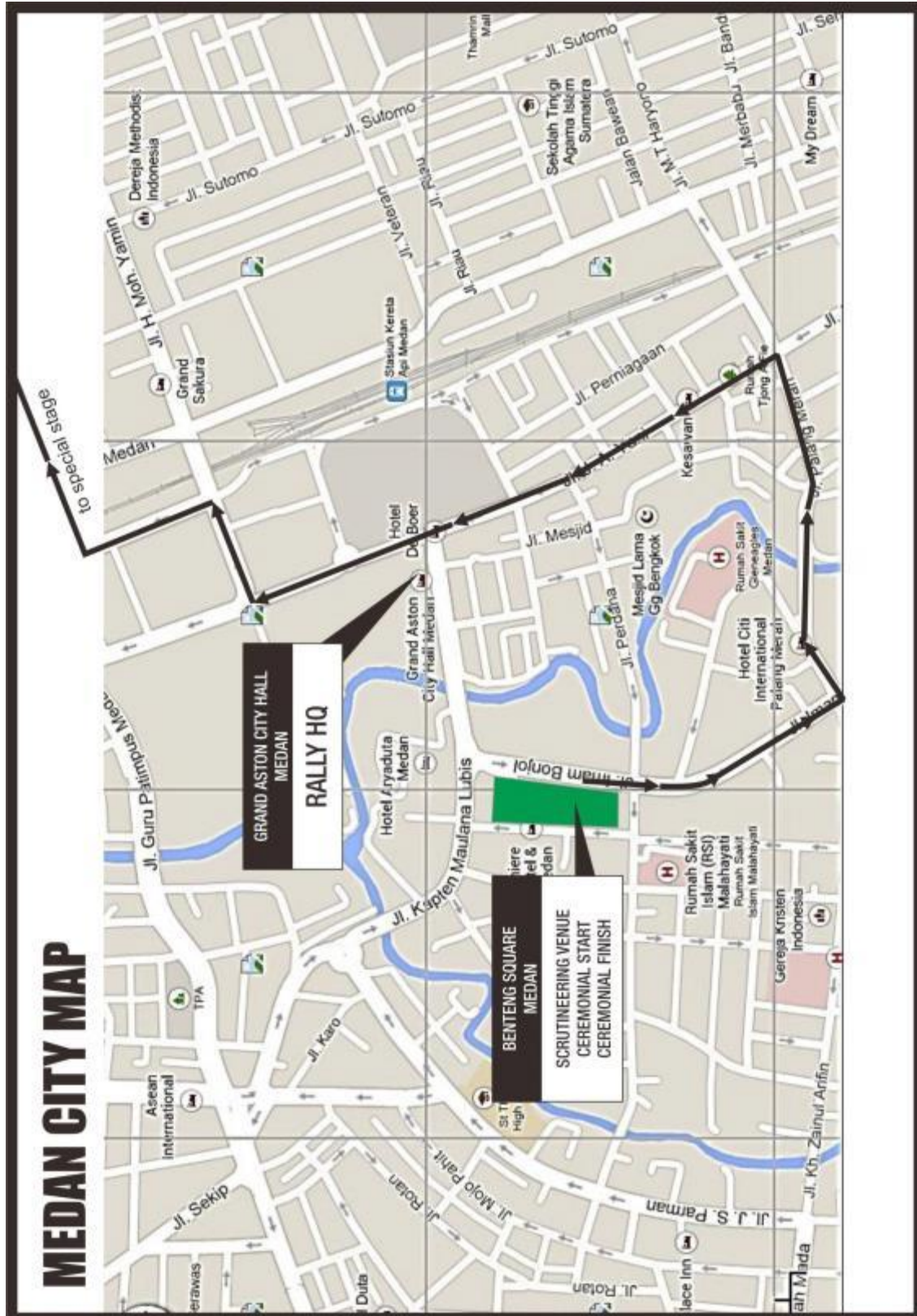

B2. ROUTE MAP

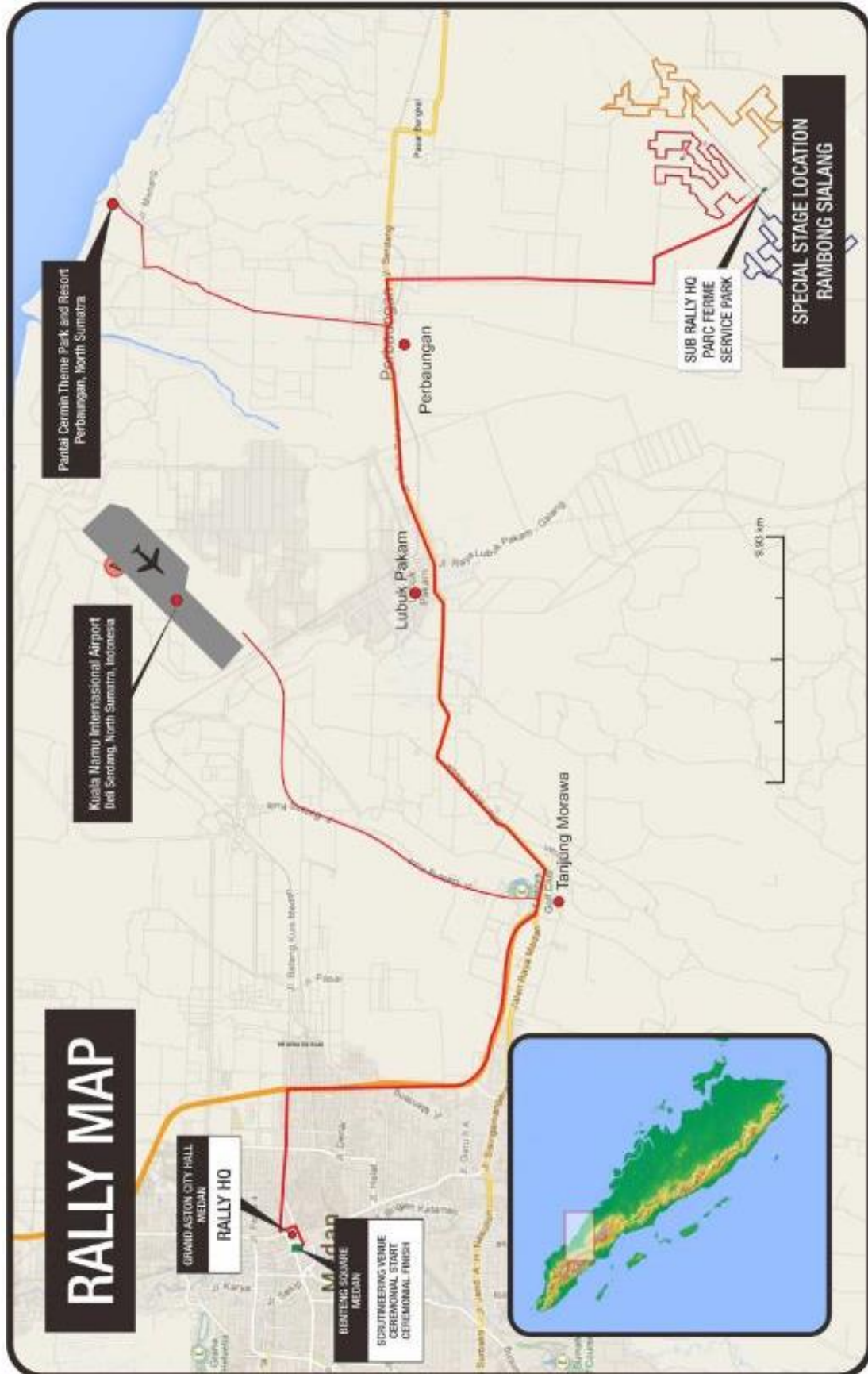

## B3. SPECIAL STAGES LEG 1

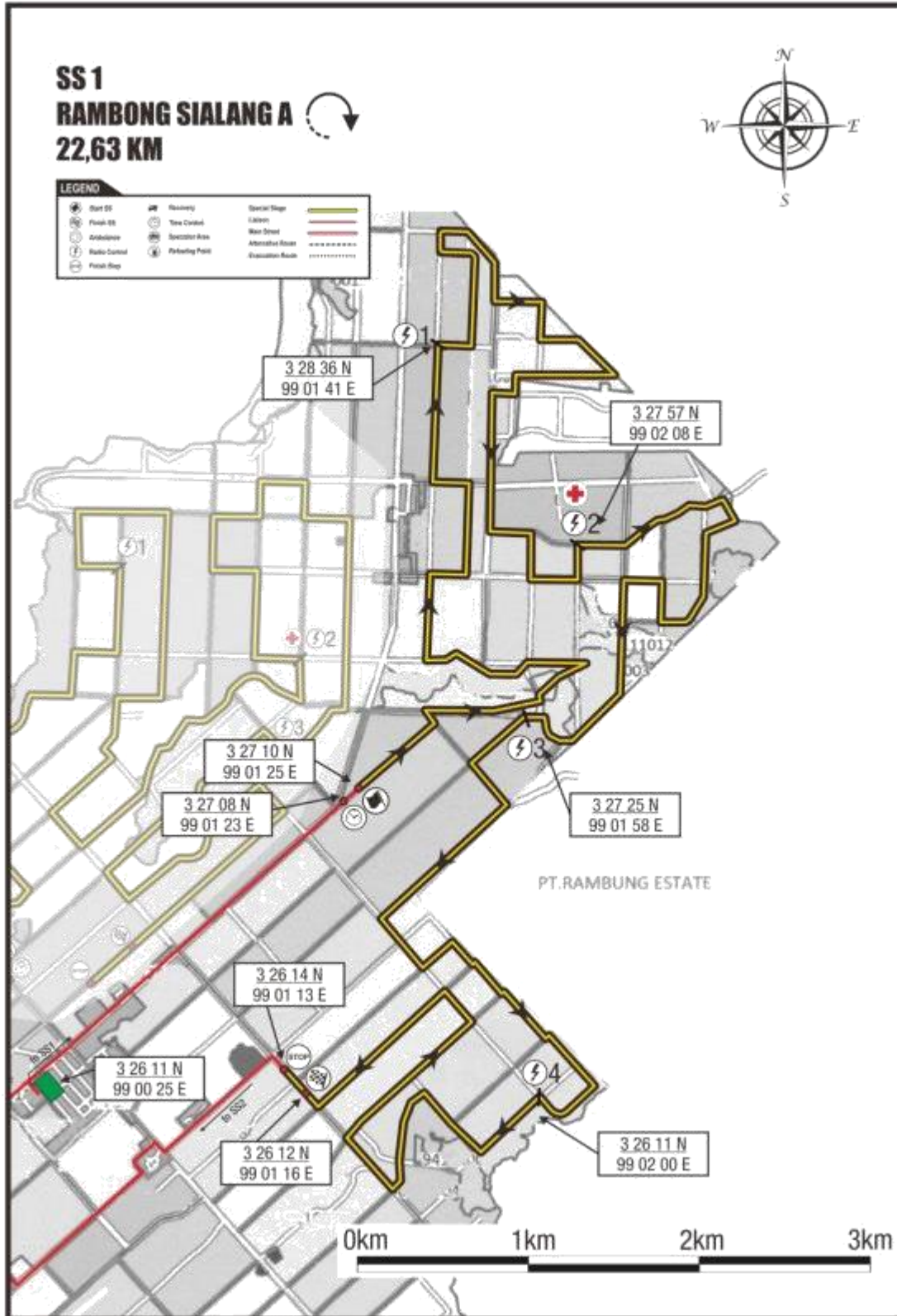

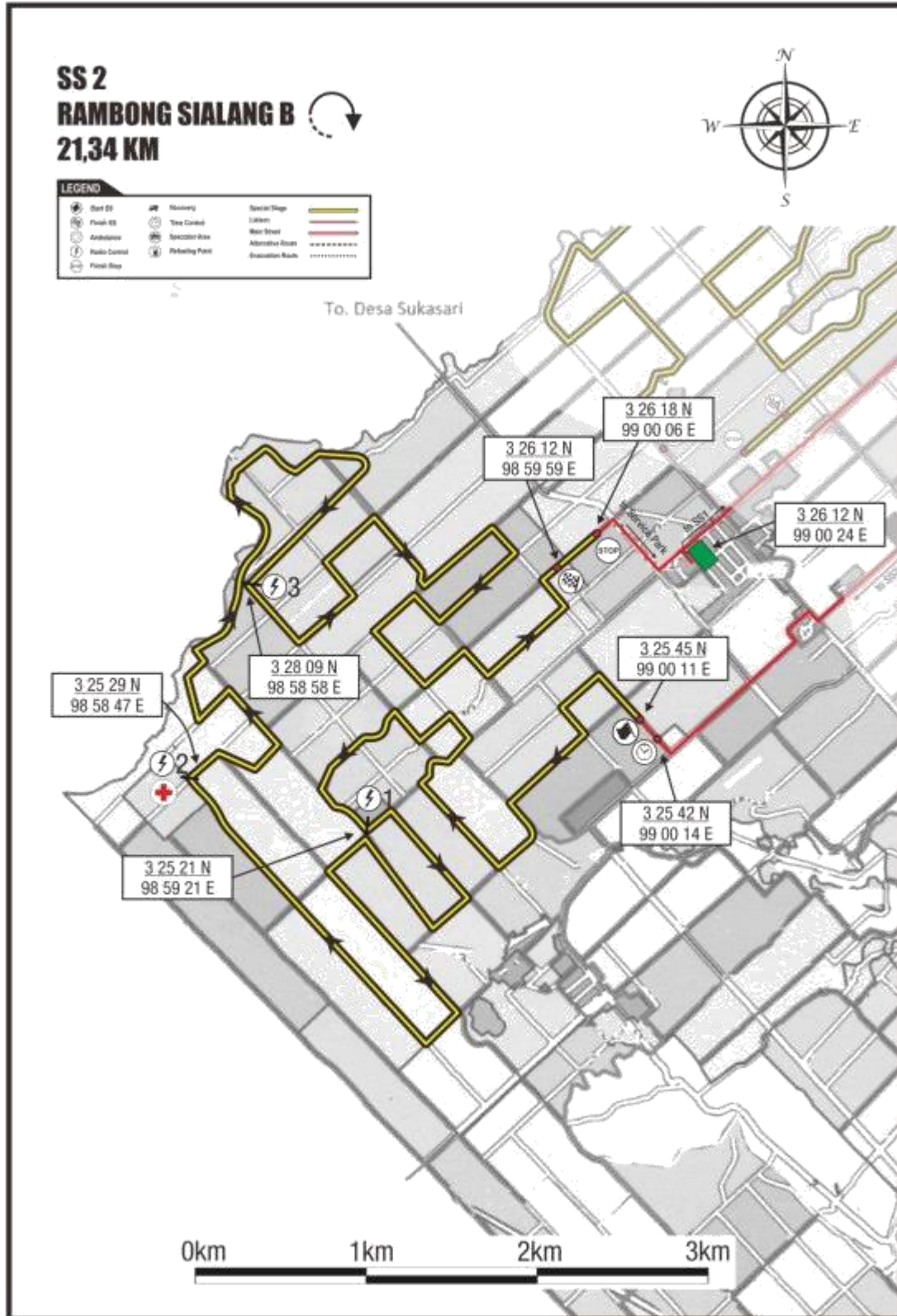

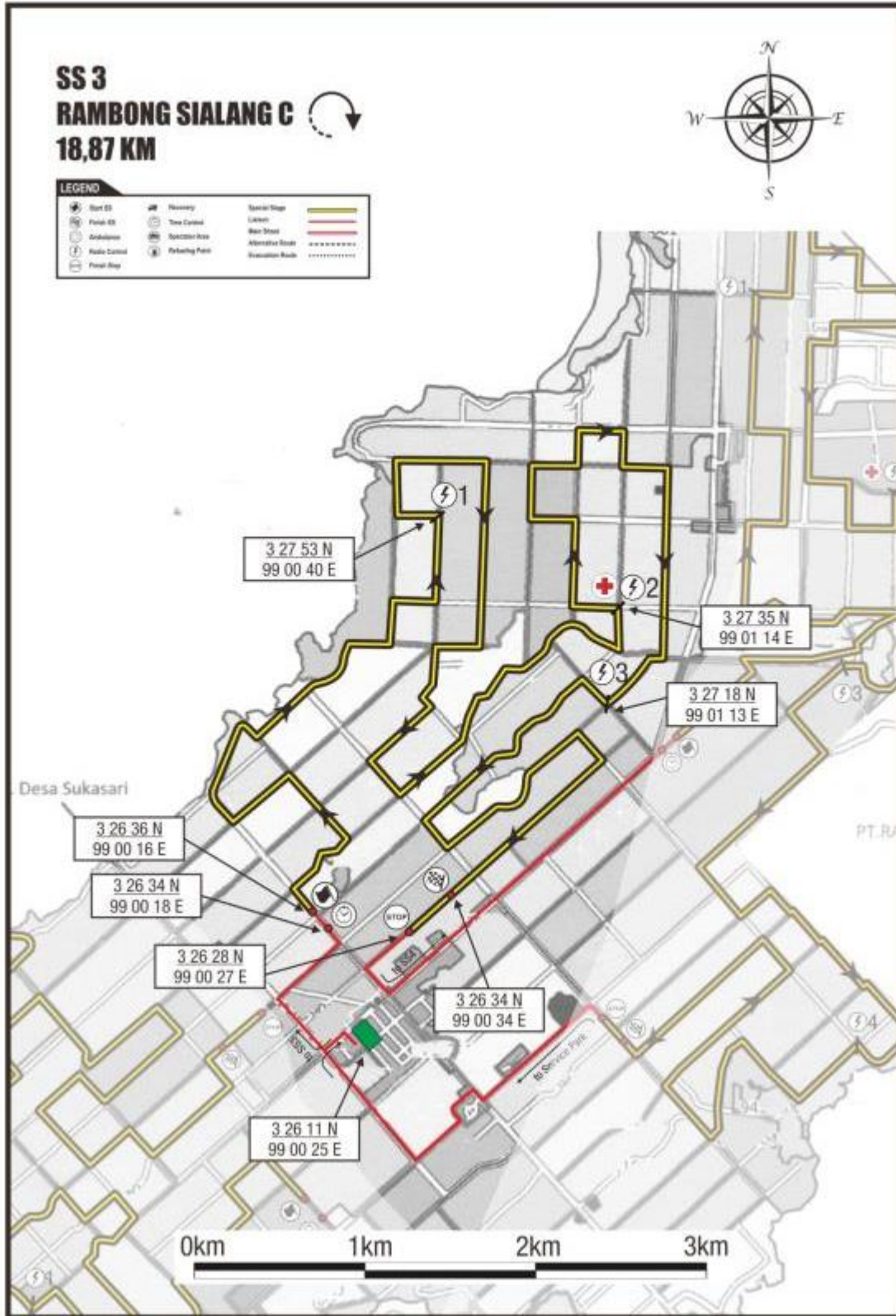

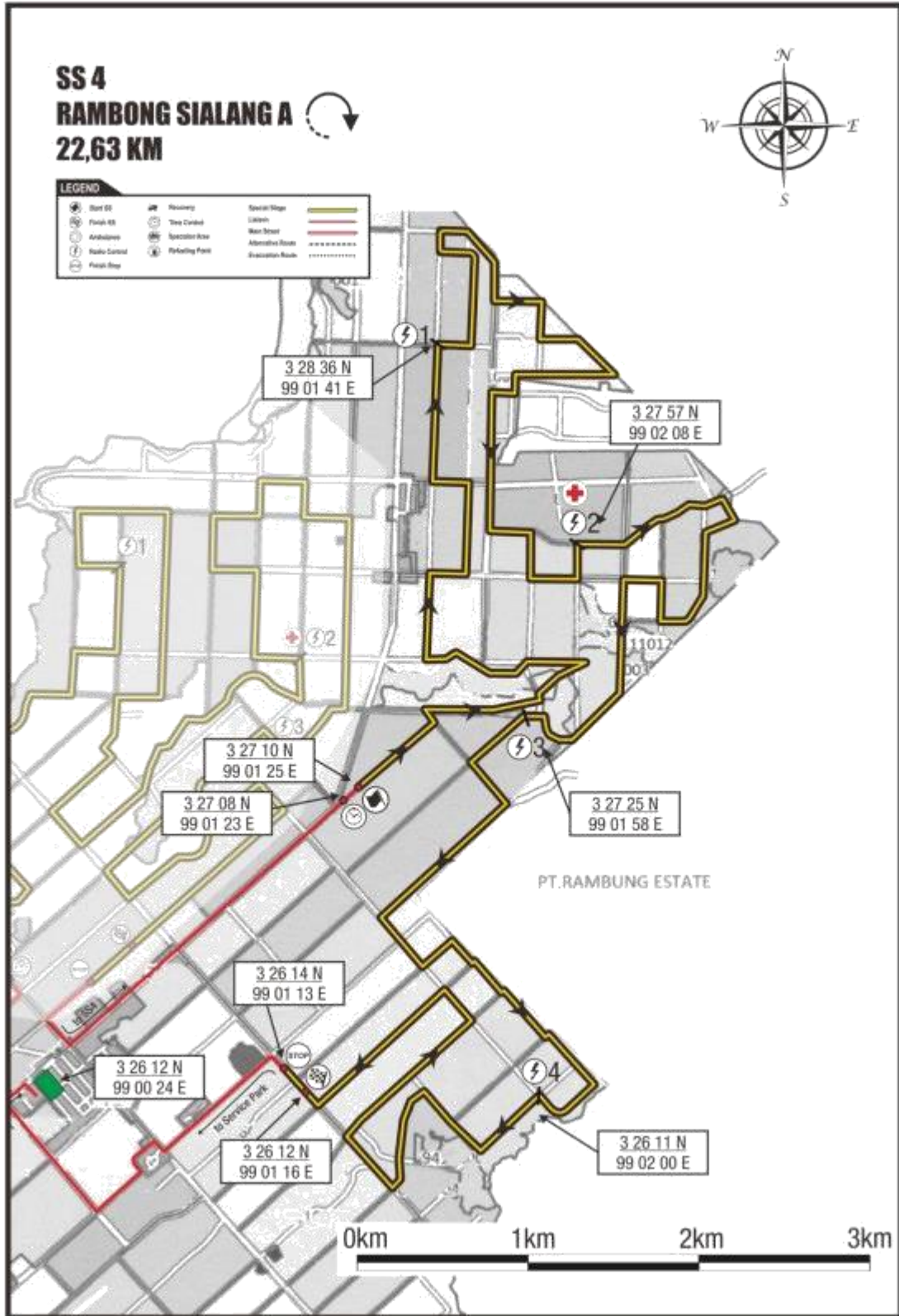

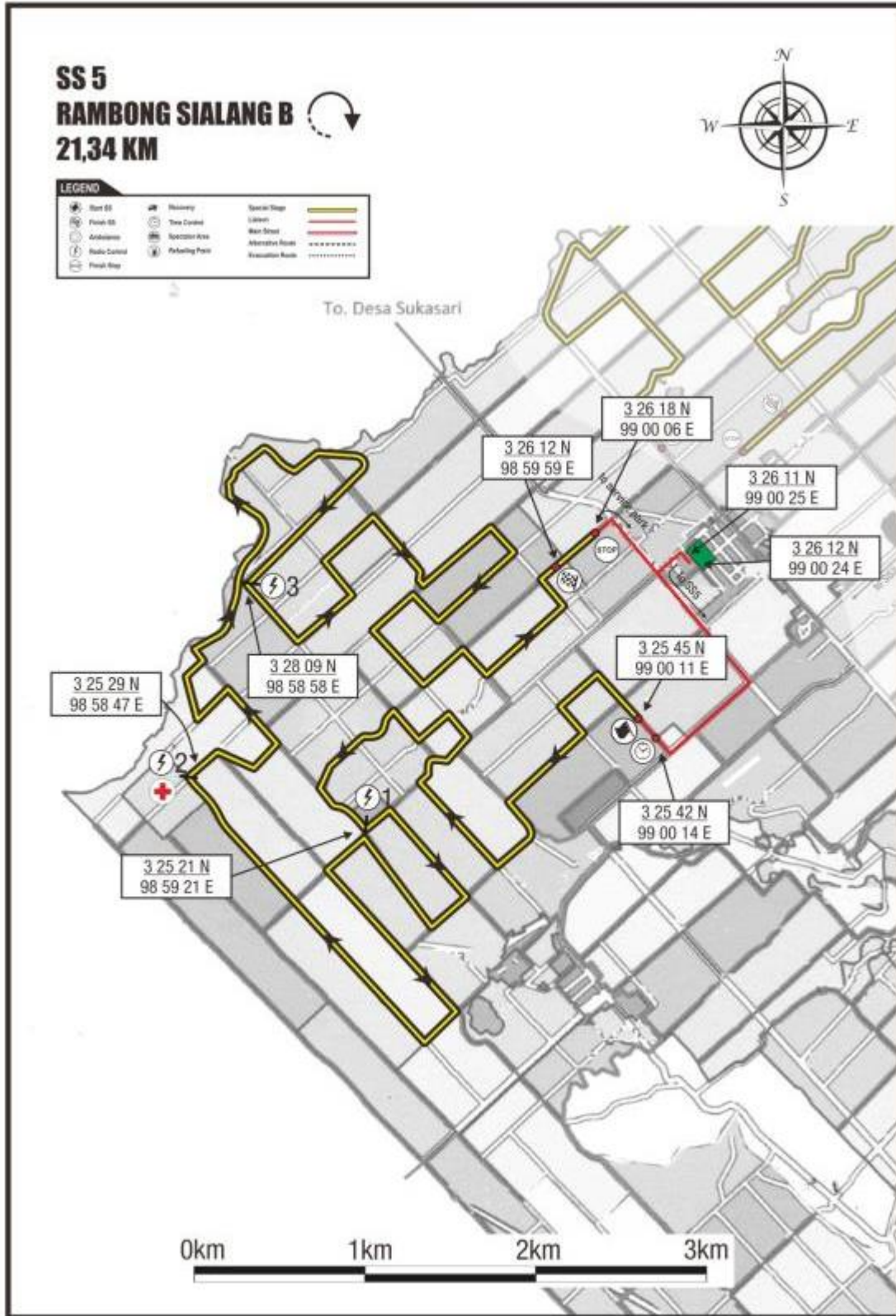



## B4. SPECIAL STAGES LEG 2

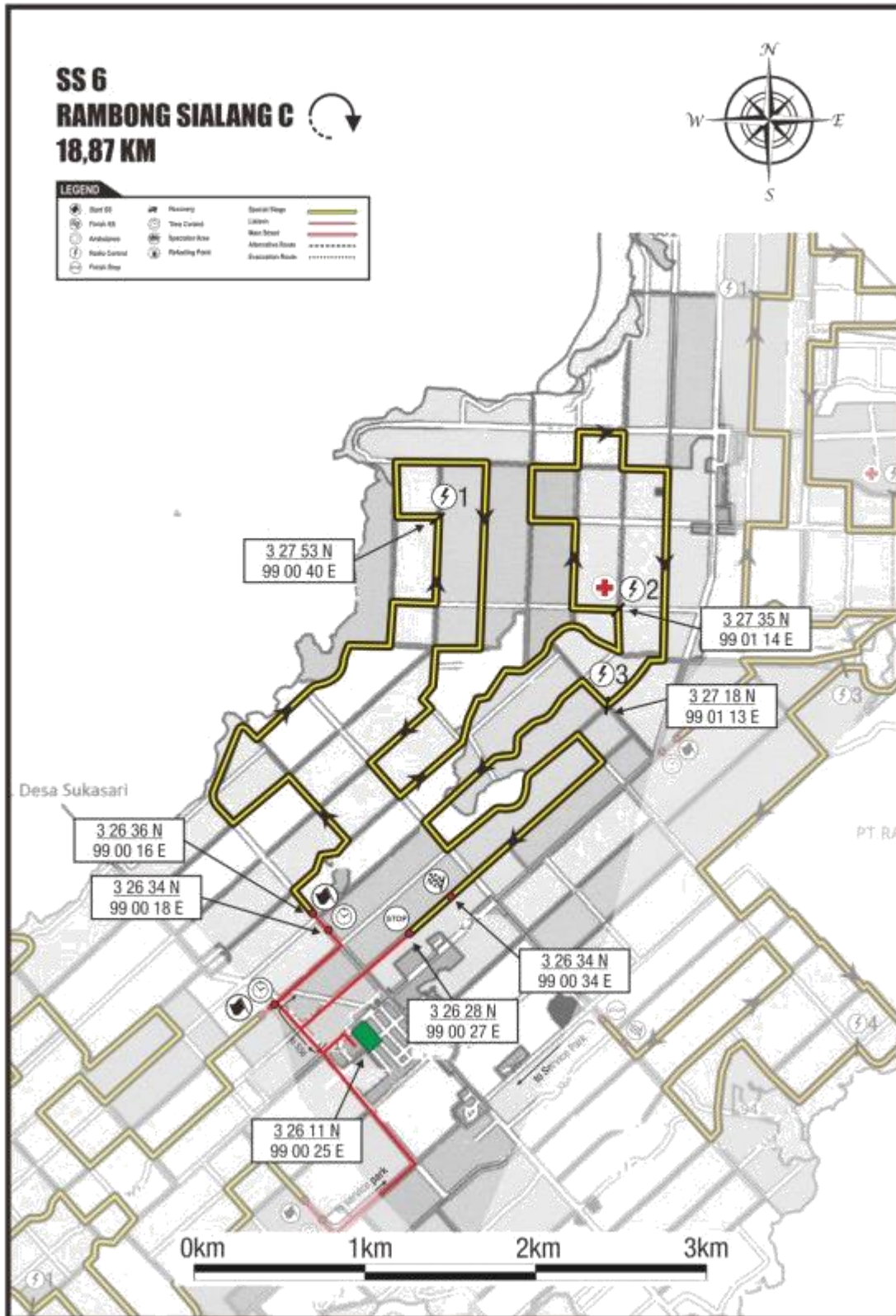

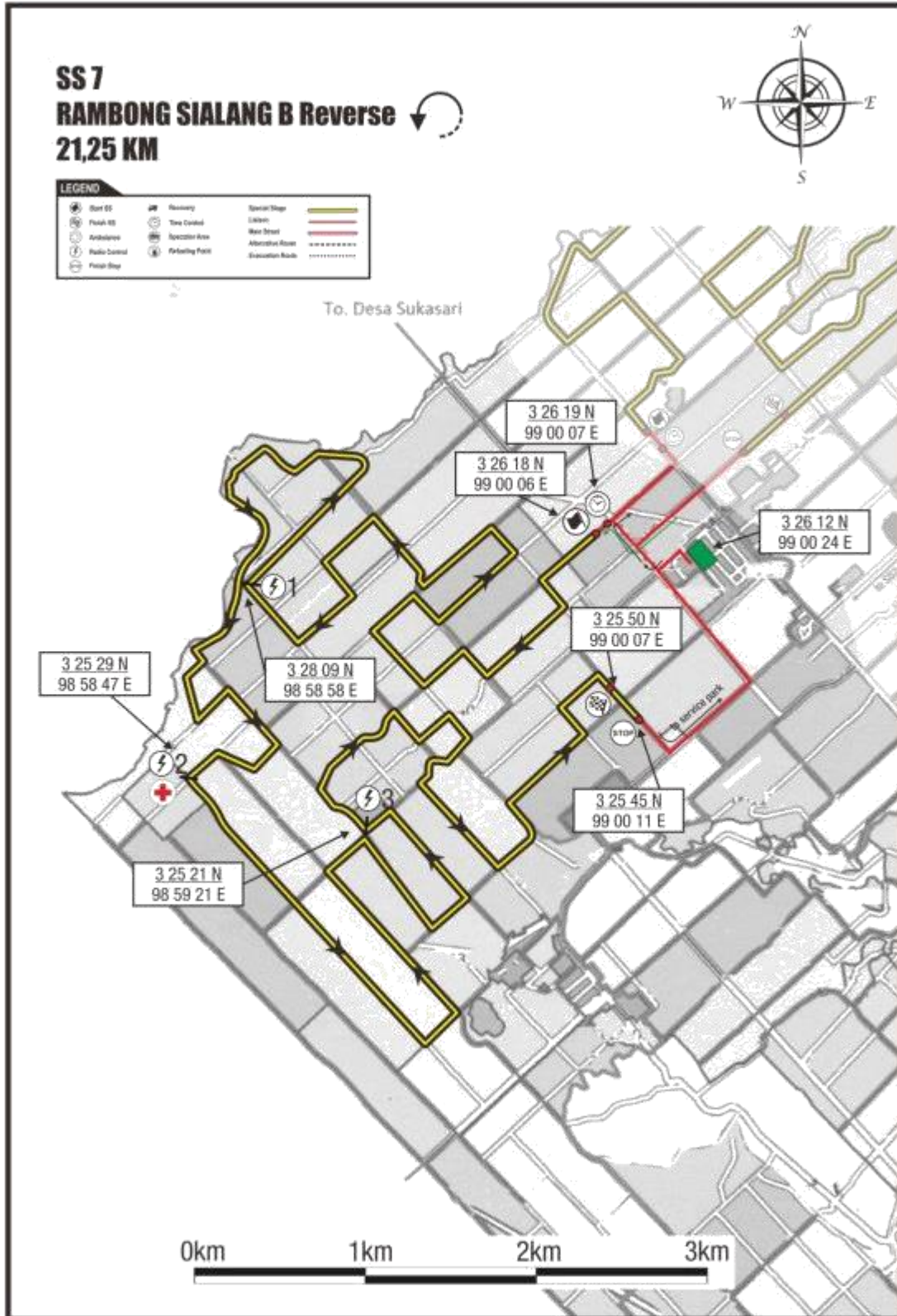

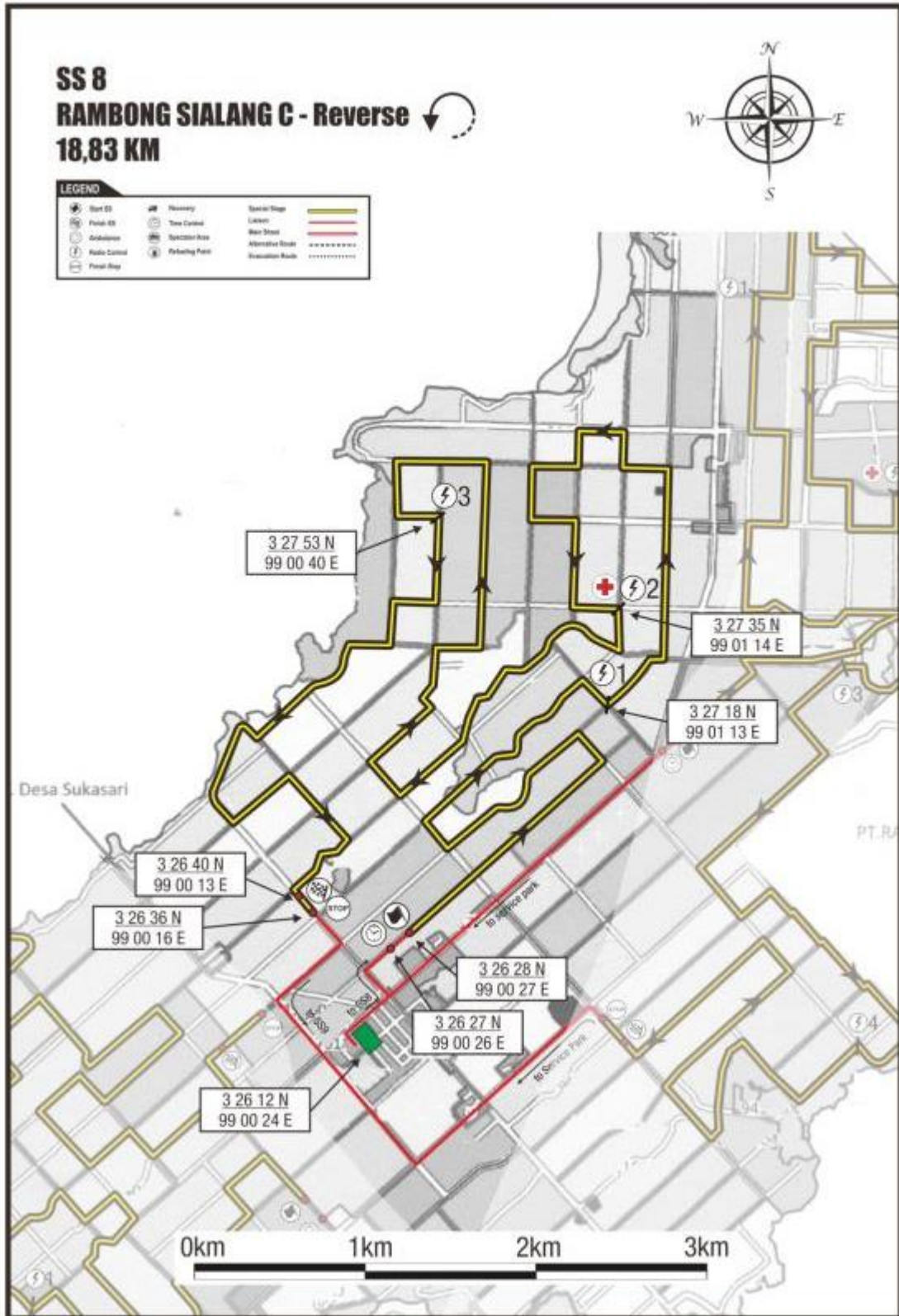

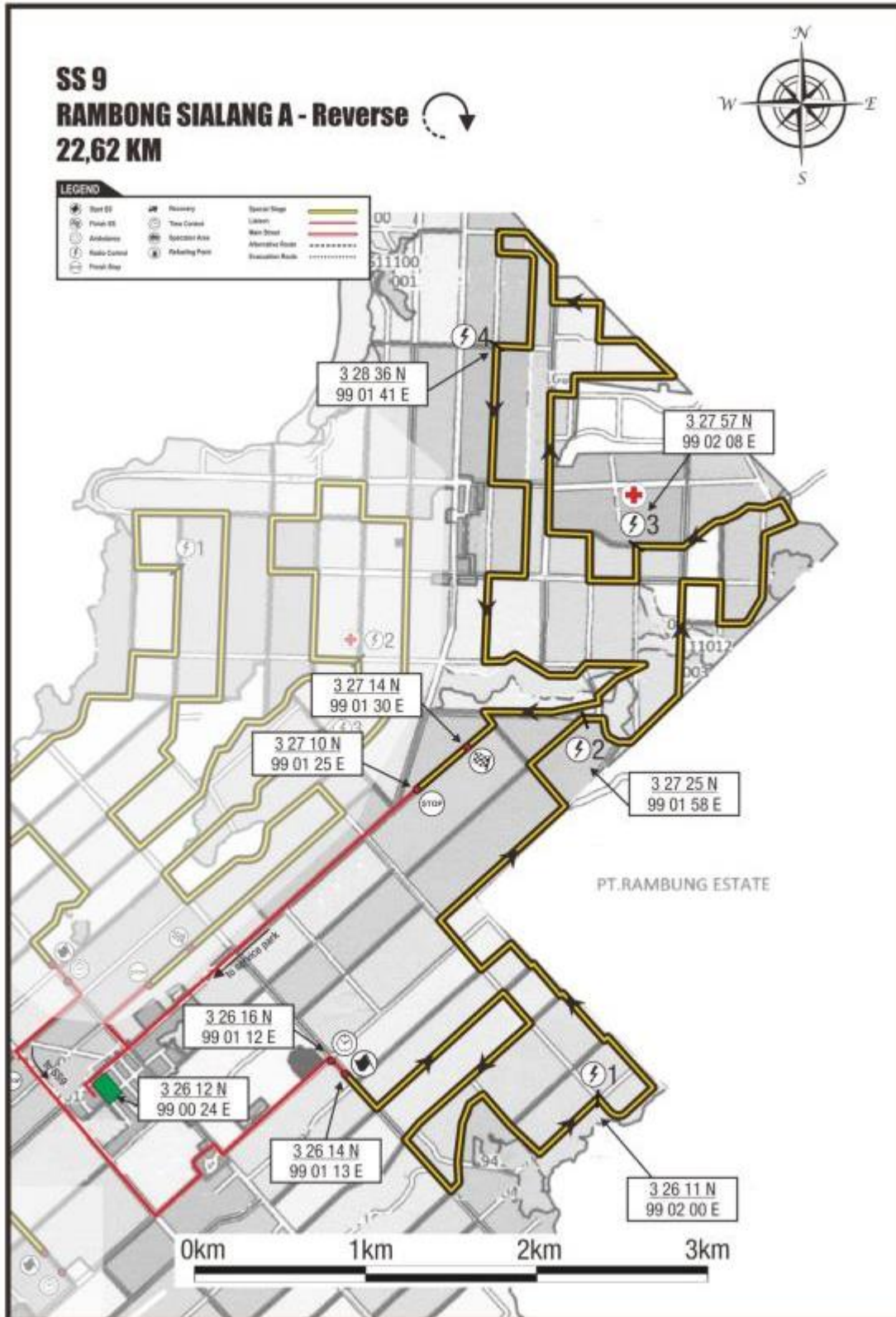

APPENDIX C : LAYOUT

C1. LAY OUT OF SCRUTINEERING AREA

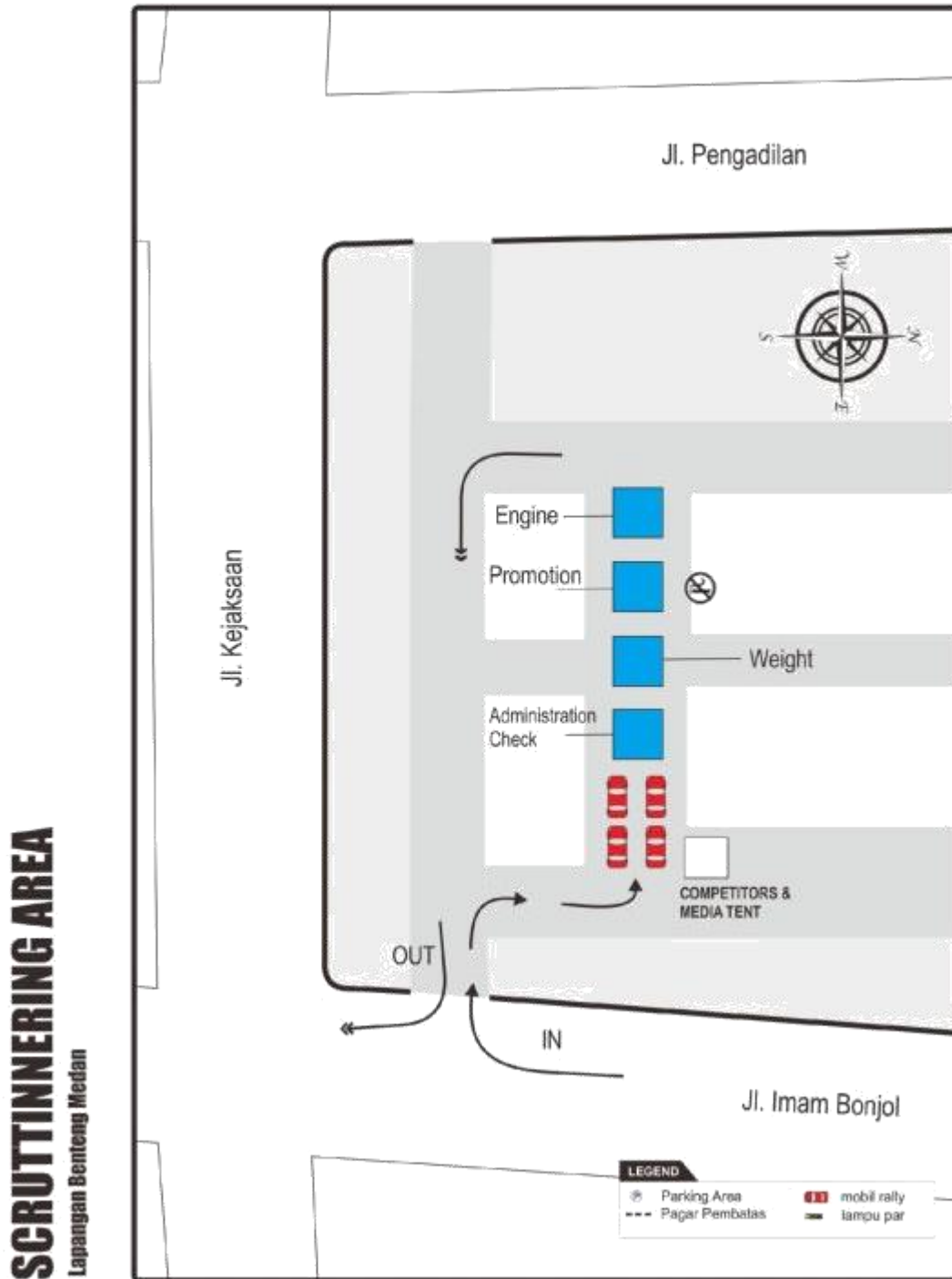

C2. LAY OUT OF CEREMONIAL START

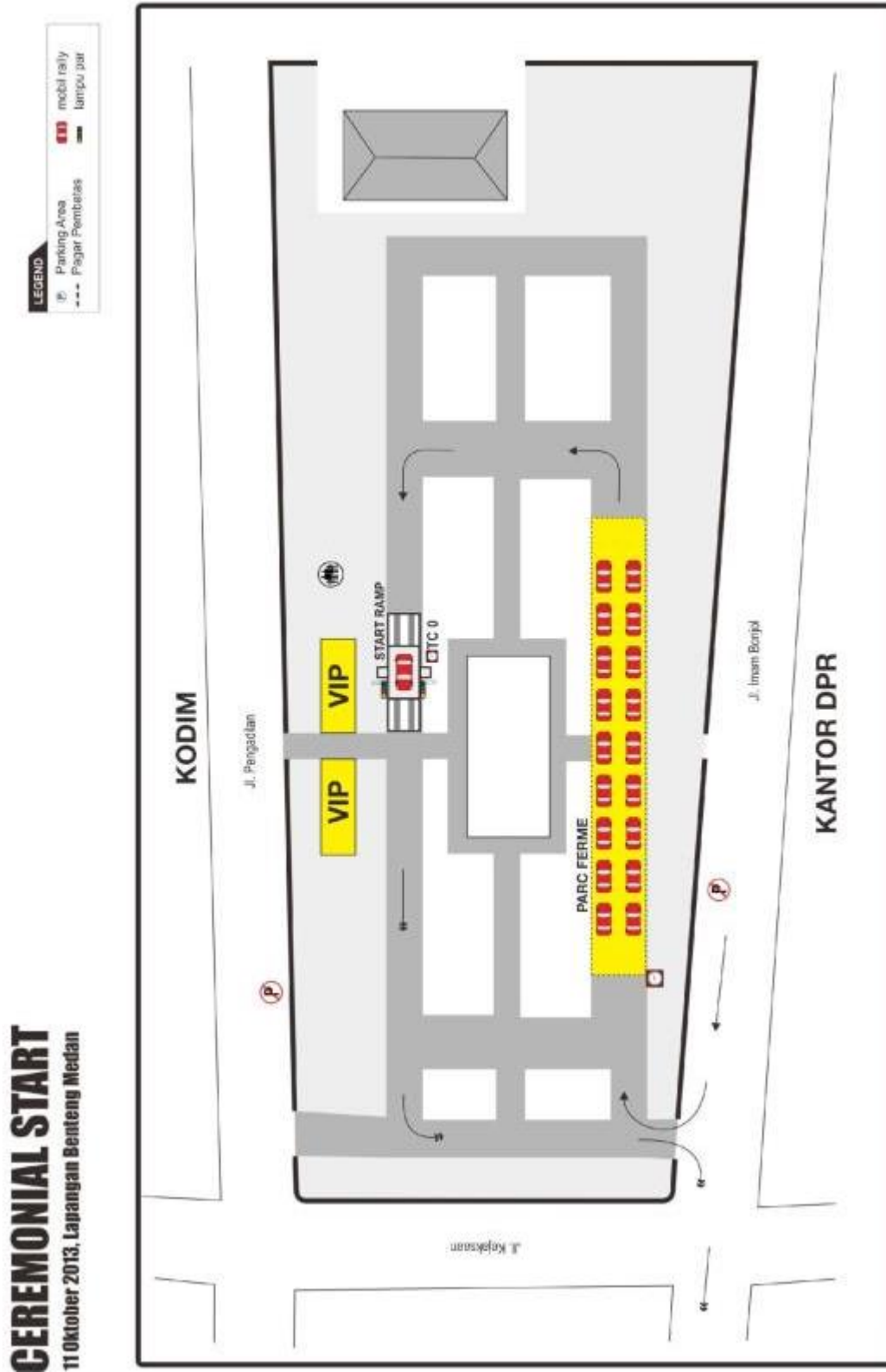

**C3. SUB RALLY HQ RAMBONG SIALANG**

**SUB HQ RAMBONG SIALANG**

(N3° 26' 11" - N99° 00' 27")

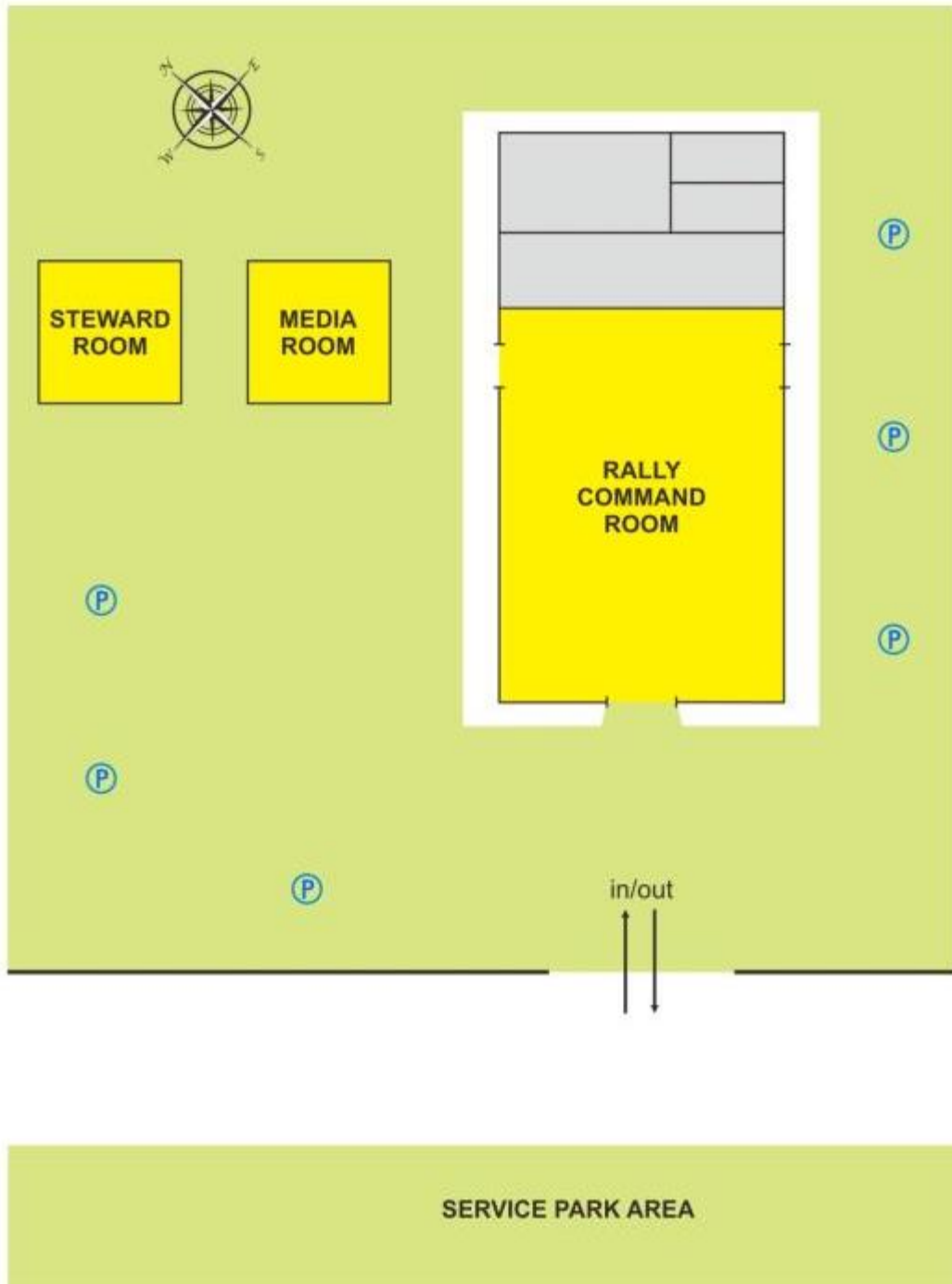

## C4. SERVICE PARK & REGROUP RAMBONG SIALANG

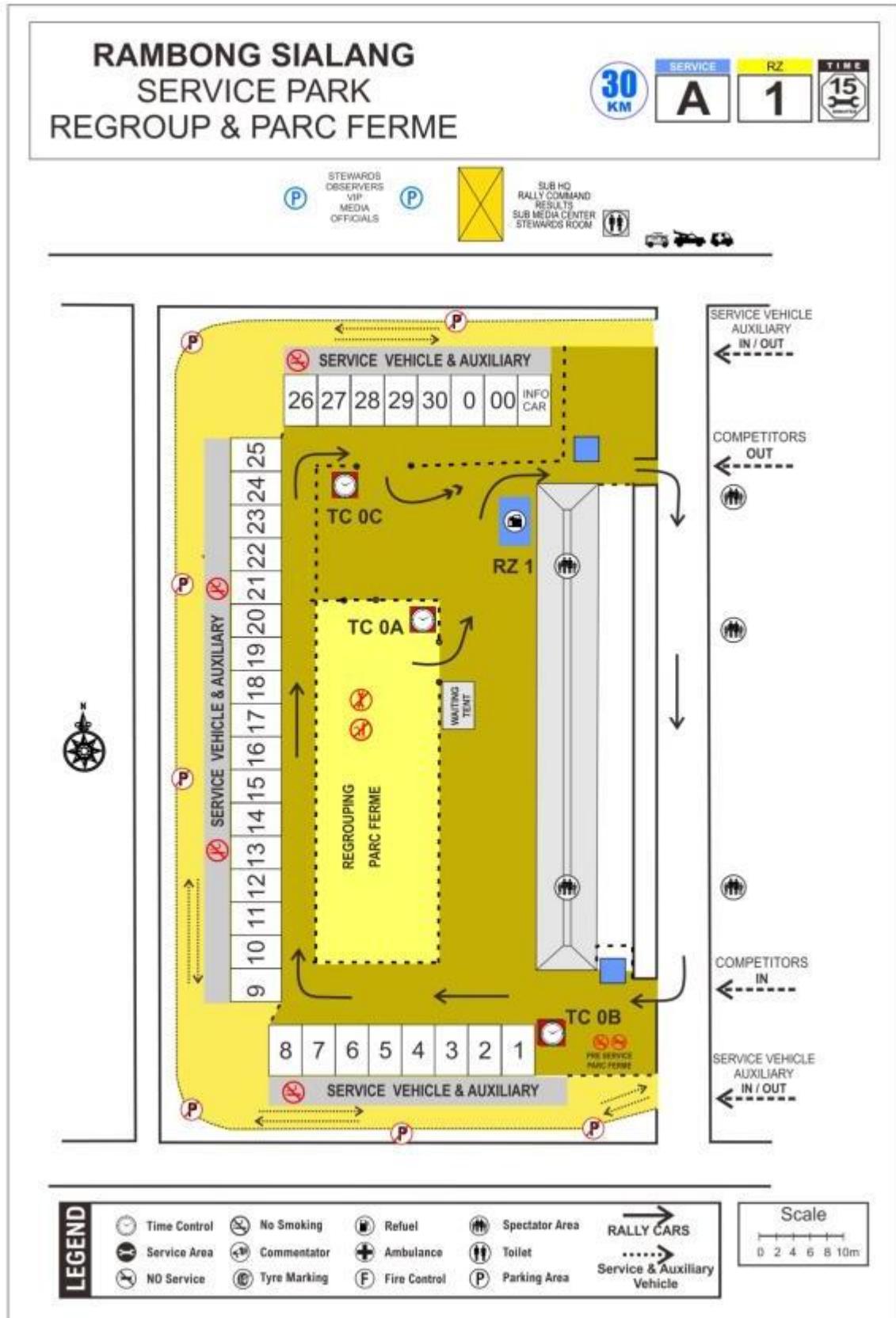



C5. LAY OUT OF CEREMONIAL FINISH

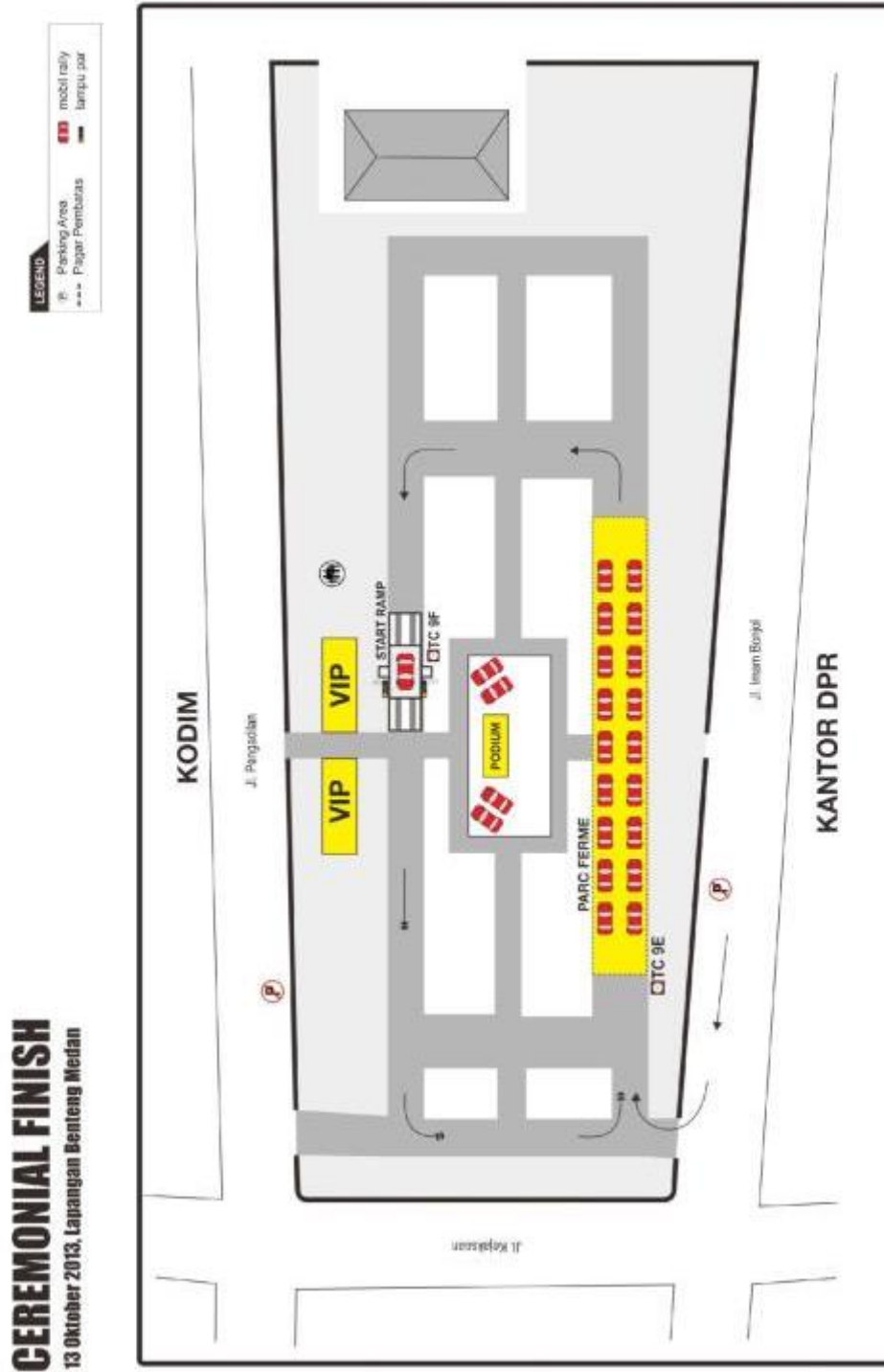



## RALLY GUIDE 1

### APPENDIX E : FORMS

#### E1. ENTRY FORM

## ENTRY FORM

	ENTRANT	FIRST DRIVER	CO-DRIVER
Entrant Name			
Family Name			
First (given) Name			
Date of Birth			
Nationality (as passport)			
Postal Address			
Passport Number			
Address for Correspondence	<input type="checkbox"/>	<input type="checkbox"/>	<input type="checkbox"/>
Telephone No. Business			
Telephone No. Private			
Mobile Telephone No.			
Fax No.			
e-mail Address			
Competition Licence No.			
Entrant Licence No.			
Issuing ASN			
Drivers Licence No.			

#### DETAILS OF THE CAR

Make		Registration No.	
Model		Capacity	
Year of Manufacture		Chasis No.	
Group / Class		Engine No.	
Homologation No.		Predominant Colour	
Type of Entry	<input type="checkbox"/> Trade / Legal etc.	<input type="checkbox"/> Private / Amateur	
Organizers Proposed Advertising Accepted	<input type="checkbox"/> Yes	<input type="checkbox"/> No	



# RALLY GUIDE 1

## For Entrants

I/We being the entrant/s of the vehicle described on this Entry Form wish to enter that vehicle for the above event.

## For Entrants and Competing Crew

I/We being the entrant/s and/or driver and/or co-driver and/or navigator, certify that the particulars on this form are true and correct in every particular, to the best of my/our knowledge and belief.

I/We declare that I/We have read and understood the Supplementary Regulations issued for the event, and agree to be bound by them and the provisions of the National Competition Rules of the Ikatan Motor Indonesia ("IMI").

In exchange for being able to attend or participate in the event (including entering the event), I agree :

- to release IMI and Ikatan Motor Indonesia, . National Promoters , Sponsor Organizations, Land Owners and Lessees, Organizers of the event, Their respective servants, Officials, Representatives and Agents (collectively, the "Associated Entities") from all liability for may death, Personal injury (including burns), psychological trauma, Loss or damage (including property damage) ("Harm") howsoever arising from my participation in or attendance at the event, except to the extent prohibited by law;
- That IMI and Associated Entities do not make any warranty, implied or express, that the event services will be provided with due care and skill or that any materials provided in connection with the services will be fit for the purpose for which they are supplied;
- To attend or participate in the event at my own risk.

I/We acknowledge that :

- The risks associated with attending or participating in the event include the risk that i may suffer harm as a result of :
  - Motor vehicles (or parts of them) colliding with other motor vehicles, persons or property ;
  - Acts of violence and other harmful acts (whether intentional or inadvertent) committed by persons attending or participating in the event;
  - The failure or unsuitability of facilities (including grand-stands, fences and guard rails) to ensure the safety of persons or property at the event.
- Motorsport is dangerous and that accidents causing harm can and do happen and may happen to me.
- The route instructions should not be relied upon exclusively in estimating the degree of severity of any hazard which might be encountered, or the manner in which any section of the road is driven, whether shown in the route instructions or not, and that I/We have been advised to exercise caution in following these route instructions.

I accept the conditions of, and acknowledge the risks arising from, attending or participating in the event and being provided with the event services by IMI and the Associated Entities.

ASN Stamp*	Signature of Entrant	Signature of 1 <sup>st</sup> Driver	Signature of Co-driver
Date : _____	Date : _____	Date : _____	Date : _____

\*Or letter form entrant's ASN authorizing and approving entry

**(For persons under the age of 18 years the following parent/guardian consent must be completed)**  
**PARENT/GUARDIAN CONSENT - PERSONS UNDER 18 YEARS OLD**

I ..... Of [Address] ..... Am the parent/guardian\* of the above named ("the minor") who is under 18 years old. I have read this document and understand its contents, including the exclusion of liability and assumption of risk, and have explained the contents to the minor. I consent to the minor attending/participating in\* the event at his/her own risk. Assumption of risk, and have explained the contents to the minor. I consent to the minor attending/participating in\* the event at his/her own risk.

Date .....

Signed .....  
Parent/Guardian\*

\* Delete whichever does not apply

**All the above details must be completed prior to submitting the entry form**

**Please forward completed entry forms to :**  
**INDONESIA RALLY 2013**

**Pengprov IMI Sumut**  
jl Taruma 52  
Medan 20122

Fax: +62 61 452 0672  
Email: info\_sekretaris@imi-sumut.or.id

## AUTHORIZATION

- Please find cheque attached  
 Charge to Credit Card

In signing this form you agree that all chargers for entry will be change as stated above.

\_\_\_\_\_  
ENTRANT NAME

\_\_\_\_\_  
SIGNATURE